

* Some of the contents in this manual may differ from your phone, depending on the software installed or your service provider.



DUAL BAND GSM TELEPHONE SGH-T200



Printed in Korea

World Wide Web

Code No.: GH68-03376A

<http://www.samsungmobile.com>

English. 11/2002. Rev. 1.0

Contents

Important Safety Precautions	7
Unpacking	9
Your Phone	10
Phone Layout	10
Display	13
Getting Started	16
Installing the SIM Card	16
Charging a Battery	18
Switching the Phone On/Off	22
Call Functions	23
Making a Call	23
Adjusting the Volume	25
Answering a Call	26
Viewing Missed Calls	27
Quickly Switching to Silent Mode	29
Selecting Functions and Options	30
Example: Setting the Display Language	32
Phonebook	34
Storing a Number with a Name	34
Using Phonebook Entry Options	36
Searching for a Number in the Phonebook	38
Editing a Caller Group	40
Speed-dialling	41
Checking Memory Status	42
Entering Text	43
Changing the Text Input Mode	44
Using the T9 Mode	45
Using the Symbol Mode	46
Using the Upper/Lower-case Character Mode	47
Using the Number Mode	48

Options During a Call	49
Putting a Call on Hold	49
Switching the Microphone Off (Mute)	50
Muting/Sending Key Tones	51
Searching for a Number in the Phonebook	51
Using the SMS Service	52
Answering a Second Call	52
Making a Multiparty Call	53
Using the Menus	55
Accessing Menu Functions by Scrolling	55
Accessing Menu Functions by Using Shortcuts	56
List of Menu Functions	57
Messages	61
Read Messages (<i>Menu 1.1</i>)	61
Write Messages (<i>Menu 1.2</i>)	62
Templates (<i>Menu 1.3</i>)	64
Setup (<i>Menu 1.4</i>)	65
Broadcast (<i>Menu 1.5</i>)	66
Voice Mail (<i>Menu 1.6</i>)	67
My Contents (<i>Menu 1.7</i>)	68
Memory Status (<i>Menu 1.8</i>)	68
Call Records	69
Missed Calls (<i>Menu 2.1</i>)	69
Received Calls (<i>Menu 2.2</i>)	69
Dialled Calls (<i>Menu 2.3</i>)	70
Call Time (<i>Menu 2.4</i>)	70
Call Cost (<i>Menu 2.5</i>)	71
Sound Settings	72
Ring Tone (<i>Menu 3.1</i>)	72
Ring Volume (<i>Menu 3.2</i>)	72
Alert Type (<i>Menu 3.3</i>)	73
Keypad Tone (<i>Menu 3.4</i>)	73
Message Tone (<i>Menu 3.5</i>)	74
AutoFolder Tone (<i>Menu 3.6</i>)	75
Extra Tones (<i>Menu 3.7</i>)	75

Phone Settings	76
Infrared Activate (<i>Menu 4.1</i>)	76
My Settings (<i>Menu 4.2</i>)	77
Greeting Message (<i>Menu 4.3</i>)	78
Own Number (<i>Menu 4.4</i>)	79
Language (<i>Menu 4.5</i>)	79
Security (<i>Menu 4.6</i>)	79
LCD Settings (<i>Menu 4.7</i>)	82
Extra Settings (<i>Menu 4.8</i>)	84
Short Cut (<i>Menu 4.9</i>)	86
Reset Settings (<i>Menu 4.10</i>)	87
Organiser	88
Calendar (<i>Menu 5.1</i>)	88
To Do List (<i>Menu 5.2</i>)	90
Time & Date (<i>Menu 5.3</i>)	93
Alarm (<i>Menu 5.4</i>)	94
Calculator (<i>Menu 5.5</i>)	95
Currency Exchange (<i>Menu 5.6</i>)	96
Network Services	97
Call Diverting (<i>Menu 6.1</i>)	97
Call Barring (<i>Menu 6.2</i>)	99
Call Waiting (<i>Menu 6.3</i>)	101
Network Selection (<i>Menu 6.4</i>)	102
Caller ID (<i>Menu 6.5</i>)	103
Closed User Group (CUG) (<i>Menu 6.6</i>)	103
Fun Box	105
Games (<i>Menu 7.1</i>)	105
WAP Browser (<i>Menu 7.2</i>)	106
Downloads (<i>Menu 7.3</i>)	112
Solving Problems	113

Access Codes	116
Phone Password	116
PIN	117
PUK	117
PIN2	118
PUK2	118
Barring Password	119
Health and Safety Information	120
Exposure to Radio-Rrequency Energy (SAR Information)	120
Precautions When Using Batteries	122
Road Safety	124
Operating Environment	126
Potentially Explosive Atmospheres	128
Emergency Calls	129
Other Important Safety Information	130
Care and Maintenance	131
Glossary	133
Quick Reference Card	137

Important Safety Precautions

Read these guidelines before using your wireless phone. Failure to comply with them may be dangerous or illegal. For more detailed safety information, see "Health and Safety Information" on page 120.

Road Safety at All Times

Do not use a hand-held phone while driving; park the vehicle first.

Switching Off When Refuelling

Do not use the phone at a refuelling point (service station) or near fuels or chemicals.

Switching Off in Aircraft

Wireless phones can cause interference. Using them in aircraft is both illegal and dangerous.

Switching Off in Hospitals

Switch off your phone near medical equipment. Follow any regulations or rules in force.

Interference

All wireless phones may be subject to interference, which could affect their performance.

Special Regulations

Meet any special regulations in force in any area and always switch off your phone whenever it is forbidden to use it, or when it may cause interference or danger (in a hospital for example).

Radio Frequency Exposure

The design of this phone complies with European Union (EU) requirements relating to radio frequency (RF) exposure. To maintain compliance with these requirements, use only Samsung-supplied or approved accessories. Use of non-approved accessories may violate the requirements.

Sensible Use

Use only in the normal position (held to the ear). Avoid unnecessary contact with the antenna when the phone is switched on.

Accessories and Batteries

Use only Samsung-approved accessories and batteries.

Qualified Service

Only qualified service personnel may install or repair your phone.

Unpacking

Your package contains the following items.



Handset

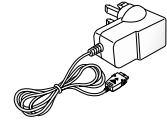

Travel Adapter*

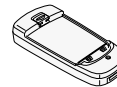

Battery Charger



Batteries



User's Manual



Ear-microphone



Hand Strap

* The Shape of the plugs may vary according to the country's specification.

In addition, you can obtain the following accessories for your phone from your local Samsung dealer.

- Ear-microphone
- Standard/Extended batteries
- Simple hands-free kit
- Car holder
- Cigarette lighter adapter

Your Phone

Phone Layout

The following illustrations show the main elements of your phone.



Key Description



Perform the functions indicated by the text above them on the bottom line of the display.



In menu mode, scroll through the menu options and phonebook memory.

In idle mode, allow you to access your favourite menu option directly ; for more information about shortcuts, see page 86.



In menu mode, return to the previous menu level and select the current menu respectively.

When entering text, move the cursor to the left and to the right respectively.

In idle mode, allow you to access your favourite menu option directly ; for more information about shortcuts, see page 86.



In idle mode, quickly launches the WAP browser.



Makes or answers a call.

When held down in idle mode, recalls the last number dialled or received.

In menu mode, selects a menu function or stores information that you have entered, such as a name, in the phone or SIM memory.

Key **Description** *(Continued)*

Deletes characters from the display.

In menu mode, returns to the previous menu level.



Ends a call. Also switches the phone on and off when held down.

In menu mode, cancels your input and returns to idle mode.



In idle mode, allows you to quickly access your voice mail server when held down.



Enter numbers, letters and some special characters.



Enter special characters.



Perform various functions.



(on the left side of the phone)
During a call, adjust the earpiece volume.

In idle mode, adjust the key tone volume.

In menu mode, scroll through the menu options and phonebook memory.



(on the right side of the phone)
Opens or closes the folder.





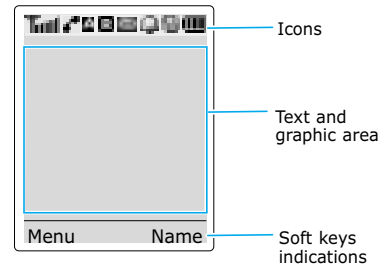





Display**Display Layout**

The display comprises three areas.



Area	Description
First line	Displays various icons (see page 14).
Middle lines	Display messages, instructions and any information that you enter (number to be dialled, for example).
Last line	Shows the functions currently assigned to the two soft keys.

Icons

Icon	Description
	Shows the received signal strength. The greater the number of bars, the stronger the signal strength.
	Appears when a call is in progress.
	Appears when you are out of your home area and have registered onto a different network, for example, when travelling in other countries.
	Appears when a new text message is received.
	Appears when a new voice mail message is received.
	Appears when the IrDA port is active. For details, see page 76.
	Appears when you are entering English text.
	Appears when you set an alarm.
	Appears when silent mode is active or when you set the phone to vibrate when a call comes in via the Alert Type menu option (Menu 3.3).
	Appears when mute mode is active.
	Shows the level of your battery. The more bars you see, the more power you have left.

Backlight

The display is illuminated by a backlight. When you press any key, the backlight illuminates. It turns off if no key is pressed within a given period of time, depending on the **Back Light** option in the **Phone Settings** menu.

To specify the length of time for which the backlight is active, set the **Back Light** menu option (**Menu 4.7.2**); see page 83 for further details.

You can also set the phone to use the backlight only during a specified period time via the **Auto Light** menu option (**Menu 4.7.3**); see page 83 for further details.

External Display

Your phone has an external display on the folder. It indicates when you have an incoming call or a message. It also alerts you when you set an alarm at the specified time.

When you press and hold down one of the volume keys on the left side of the phone with the folder closed, the backlight of the external display illuminates.

Getting Started

Installing the SIM Card

When you subscribe to a cellular network, you are provided with a plug-in SIM card loaded with your subscription details, such as your PIN, any optional services available and so on.

Important! The plug-in SIM card and its contacts can be easily damaged by scratching or bending, so be careful when handling, inserting or removing the card.

Keep all SIM cards out of the reach of small children.

1. If necessary, switch off the phone by holding down the  key until the power-off image is displayed.
2. Remove the battery. To do so:
 - ① Press the catch above the battery towards the top of the phone and hold it in that position.
 - ② Lift the battery away, as shown.

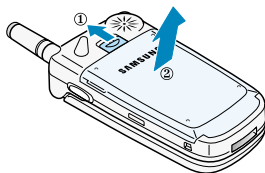

3. Slide the SIM card into the SIM card socket so that it locks the card in position. Make sure that the notched corner is at the top left and the gold contacts of the card face into the phone.

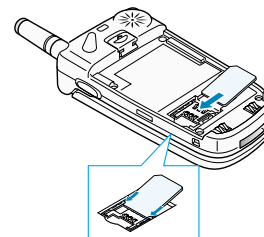

Note: When you need to remove the SIM card, slide it, as shown, and take it out of the socket.

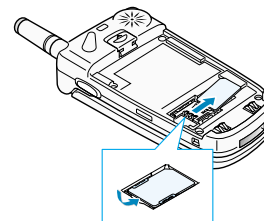

4. Place the battery back to match the tabs on it to the holes at the bottom of the phone.

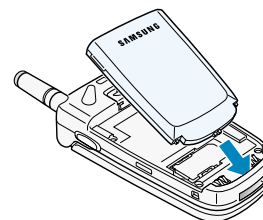

5. Press the battery down until it clicks into place.

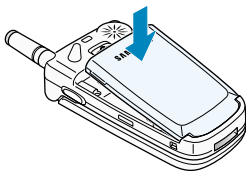

Charging a Battery

Your phone is powered by a rechargeable Li-ion battery. A travel adapter and a battery charger are provided with your phone. Use only approved batteries and chargers. Ask your local Samsung dealer for further details.

Note: You must fully charge the battery before using your phone for the first time. A discharged battery is fully recharged in approximately 200 minutes.

Using the Battery Charger

Using the battery charger, you can charge the battery alone.

1. Insert the battery into the charger, ensuring that the terminals on the battery are in contact with those on the charger. Press the battery down until it clicks into place.

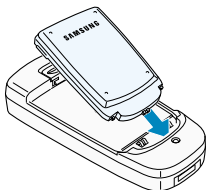

2. Plug the connector of the travel adapter into the jack at the bottom of the charger.

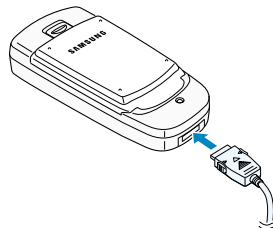

3. Plug the adapter into a standard AC wall outlet.

The LED on the charger will indicate the charging progress with the following colours:

- Red: the battery is charging
- Green: the battery is completely charged
- Yellow: the battery is not correctly plugged in or operating in a too high or too low temperature.

4. When charging is finished, unplug the adapter from both the power outlet and the charger.

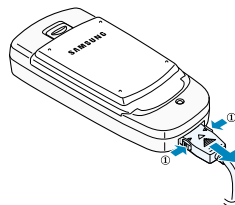

- Take the battery out of the charger.

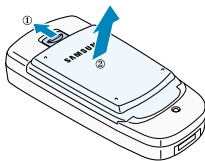

Using the Travel Adapter

The travel adapter allows you to use the phone while the battery is charging, but this will cause the phone to charge more slowly.

- With the battery in position on the phone, plug the connector of the travel adapter into the jack at the bottom of the phone.

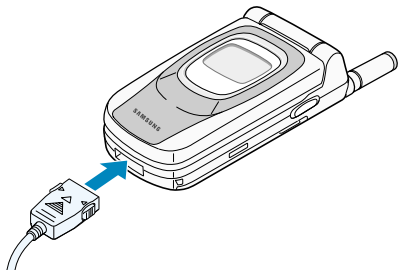

- Plug the adapter into a standard AC wall outlet.

- When charging is finished, unplug the adapter from both the power outlet and the phone.

Note: Not remove the battery from the phone without unplugging the adapter while it is charging. If you do this, the phone may be damaged.

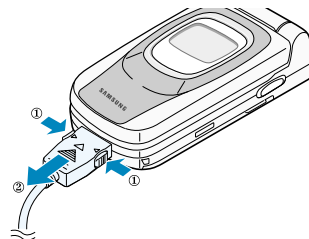

Low Battery Indicator

When the battery is weak and only a few minutes of talk time remain, you will hear a warning tone and a message will be repeated at regular intervals on the display:



When the battery becomes too weak for the phone to operate, it switches off automatically.

Switching the Phone On/Off

1. Open the folder.
2. Hold down the  key until the phone switches on.
3. If the phone asks for a password, key in the password and press the **OK** soft key. The phone password is factory set to "00000000." For further details, see page 116.
4. If the phone asks for a PIN, key in the PIN and press the **OK** soft key. For further details, see page 117.

The phone searches for your network and when it finds the network, the idle screen, illustrated below, appears on each display. Now, you can make or receive a call.

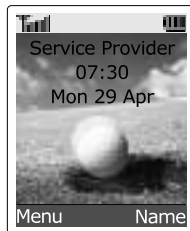

Note: To change the display language, use the **Language** menu option (**Menu 4.5**); for further details, refer to page 79.

5. When you wish to switch the phone off, hold down the  key until the power-off image is displayed.

Call Functions

Making a Call

When the idle screen is displayed, key in the area code and phone number, and press the  key.

Note: If you have checked the **Auto Redial** option in the **Extra Settings** menu (**Menu 4.8**), the number is redialled automatically up to ten times when the person does not answer your call or is already on the phone; see page 84 for further details.

Making an International Call

1. Press and hold down the **0** key. The **+** international prefix appears.
2. Key in the country code, area code and phone number and press the  key.

Correcting the Number

To clear...	Press the...
the last digit displayed	C key.
any other digit in the number	(or) key until the cursor is next to the right of the digit to be cleared. Press the C key. You can also insert a missing digit simply by pressing the appropriate key.
the whole display	C key for more than one second.







Ending a Call

When you want to finish your call, briefly press the  key.

Redialling the Last Number

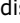
The phone stores the numbers you dialled, received or missed, if the caller is identified; see "Call Records" on page 69 for further details.

To recall any of these numbers:



1. If you have typed any characters on the display, clear the display by holding down the **C** key for more than one second.
2. Press the  key to display a list of the last numbers in order of time in which the call was made;  is displayed for dialled calls,  for received calls, and  for missed calls.
3. Use the  and  keys to scroll through the numbers until the required number is highlighted.

To...	Press the...
dial the number highlighted	 key.
edit the number highlighted	Edit soft key, and change the number as needed, referring to "Correcting the Number" on page 23 for further details.

Making a Call from the Phonebook

You can store frequently-dialled phone numbers with a name in the SIM card or the phone memory, which is called the phonebook. You then simply select the required name to recall the associated number. For further details about the Phonebook features, refer to page 34.

Adjusting the Volume

During a call, if you want to adjust the earpiece volume, use the  and  keys on the left side of the phone.

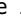
Press the  key to increase the volume level and the  key to decrease the level.

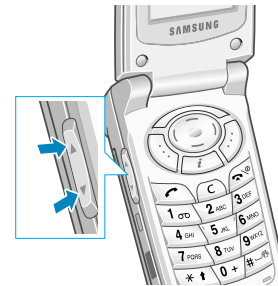

In idle mode, you can adjust the key tone volume using these keys.

Answering a Call

When somebody calls you, the phone rings and the following screens appear on each display.

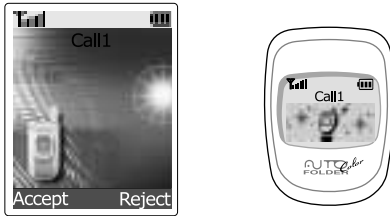

When the caller can be identified, the caller's phone number or name, if stored in your phonebook, will be displayed.

1. If necessary, open the folder. Press the  key or the **Accept** soft key to answer the incoming call.

If the **Anykey Answer** option in the **Extra Settings** menu (**Menu 4.8**) is checked, you can press any key to answer a call except for the  key and the **Reject** soft key (see page 85).

If the **Active Folder** option in the **Extra Settings** menu (**Menu 4.8**) is checked, you can answer the call simply by opening the folder (see page 85).

Note: To reject the call, press and hold one of the volume keys on the left side of the phone without opening the folder.

2. End the call by closing the folder or pressing the  key.

Note: You can answer a call while using the phonebook or menu features.



Viewing Missed Calls

If you are unable to answer a call for any reason, you can find out who was calling you, provided that this service is available, so that you can call the person back, if necessary.

The number of missed calls is displayed on the idle screen immediately after a call was missed.



To view the missed call immediately:

1. If the folder is closed, open it.
2. Press the **View** soft key.
3. The number corresponding to the most recent missed call is displayed, if available.

4. To....	Press the...
scroll through the missed calls	 or  key.
call the number displayed	 key.
edit or delete a missed call number	Select soft key (see the following section).

Editing a Missed Call Number

Note: If the number corresponding to the missed call is not available, the **Edit Number** option is not displayed.

1. Press the **Options** soft key.
2. If necessary, press the  or  key to highlight the **Edit Number** option.

- Press the **Select** soft key.
- Change the number as required.

To...	Press the...
call the number	 key.
store the number	Save soft key and enter the name and location required (for further details, refer to page 34).

Deleting a Missed Call

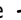
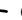
- Press the **Options** soft key.
- If necessary, press the  or  key to highlight the **Delete** option.
- Press the **Select** soft key.

You can press the  key at any time to exit the Missed Call feature.

Note: You can access the Missed Call feature at any time by selecting the **Missed Calls** menu option (**Menu 2.1**); for further details, see page 69.

Quickly Switching to Silent Mode

Silent Mode is convenient when discretion is required and you wish to stop the phone from making any noise, in a theatre for example.



In idle mode, to switch your phone quickly to the silent mode, simply press and hold down the # key until the "Silent Mode" message and vibration icon () are displayed.

In the silent mode, your phone switches the sound settings as listed below:

Option	New Setting
Alert Type (Menu 3.3)	Vibration
Keypad Tone (Menu 3.4)	OFF
Error Tone (Menu 3.7.1)	OFF

To exit the silent mode and reactivate the previous Sound Settings, press and hold the # key again until "Exit Silent Mode" appears. The vibration icon () is no longer displayed.

Selecting Functions and Options

Your phone offers a set of functions that allow you to customise your phone. These functions are arranged in menus and sub-menus, accessed via the two soft keys ( and ). Each menu and sub-menu allows you to view and alter the settings of a particular function.

The roles of the soft keys vary according to the current context; the label on the bottom line of the display just above each key indicates its current role.

Example:





Press the left soft key to enter menu mode.

Press the right soft key to enter the Phonebook menu.

To view the various functions/options available and select the required one:

1. Press the appropriate soft key.

2. To...	Press the...
select the: <ul style="list-style-type: none"> • Function displayed <u>or</u> • Option highlighted 	Select soft key or the) key.
view the next function or highlight the next option in a list	← key or ▼ key on the left side of the phone.
move back to the previous function or option in a list	→ key or ▲ key on the left side of the phone.
move back up one level in the structure	(key,  soft key or C key.
exit the structure without changing the settings	 key.

In some functions, you may be asked for a password or PIN. Enter the required code and press the **OK** soft key.

Example: Setting the Display Language

1. When the idle screen is displayed, press the **Menu** soft key to enter menu mode.

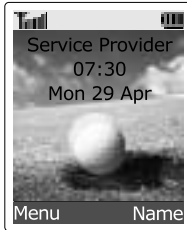

2. Scroll through the menus until you reach the **Phone Settings** menu, by pressing the **Left** and **Right** keys.

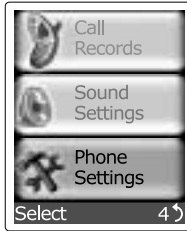

3. To select the **Phone Settings** menu, press the **Select** soft key or the **Right** key.

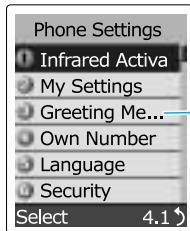

If the menu name is too long for the display, it is scrolled when highlighted.

4. Scroll through the sub-menus until you reach the **Language** sub-menu, by pressing the **Left** and **Right** keys.

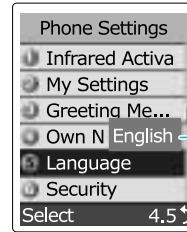

Shows the current setting.

5. To view the languages available, press the **Select** soft key or the **Right** key. The current setting is highlighted.



Current language

Note: The phone may display English only, depending on your country.

6. Scroll through the list of languages until the appropriate one is highlighted, by pressing the **Left** and **Right** keys.
7. Press the **Select** soft key or the **Right** key to confirm your selection.
8. Press the **C** or **Left** key twice to exit the menu structure.

Phonebook

You can store phone numbers and their corresponding names in the memory of your SIM card. In addition, you can store up to 500 numbers in the phone memory. The SIM card and phone memories, although physically separate, are used as if they were a single entity, called the phonebook.

Storing a Number with a Name

There two ways to store a number:



- Using the **Save** soft key in idle mode
- Using the **New Entry** option in the Phonebook menu

Storing a Number in Idle mode

As soon as you start to enter a number, **Save** appears above the left soft key to allow you to store the number in the phonebook.

1. Key in the number to be stored.

Note: If you make a mistake while entering a number, correct it using the **C** key. For further details, refer to page 23.

2. When you are sure that it is correct, press the **Save** soft key.
3. Select an icon for to identify the category of number to be stored. Three categories are available;  (mobile phone number),  (office number) and  (home number). To select the category, press the (**or**) key, followed by the **Select** soft key.

4. Enter a name and press the **OK** soft key.

The maximum length of a name depends on your SIM card. For more information about how to enter characters, see page 43.

5. Press the **OK** soft key to confirm your input.

The phone now displays the first free location in the last memory used to save a number and name. If that memory is full, the first free location in the other memory is displayed.



Note: If you change phones, any numbers stored in your SIM card memory will automatically be available with the new phone, whereas any numbers stored in the phone memory must be restored.

6. Press the right soft key, labelled as **To Card** or **To Phone** to toggle between the phone and card memories.
7. If you do not want to save the number and name in the suggested location, press the **C** key to clear the location number and enter your preferred location by pressing the number keys.
8. Press the **OK** soft key to store the name and number.

After storing, the phone displays the phonebook entry or name just created.

9. To...	Press the...
use the entry options	Options soft key. For details on the options, see page 36.
return to the idle screen	 key.

Storing a Number using the Phonebook Menu



1. When the idle screen is displayed, press the **Name** soft key.
2. Scroll to **New Entry** by pressing the  or  key and press the **Select** soft key.
3. Select an icon to identify the category of the number to be stored.

Note: The E-mail icon () is available in this step. It allows you to save an e-mail address instead of a phone number.

4. Continue the procedure from Step 4 on page 35 to store the number.

Using Phonebook Entry Options

While accessing any phonebook entry, press the **Options** soft key to access the options for the entry.

To...	Press the...
select the highlighted option	Select soft key or the key.
highlight a different option	 or  key until the required option is highlighted.

The following options are available:

Paste: allows you to paste the selected number into the normal dialling mode. Use this option to dial a number similar to one in the phonebook, for example, a different extension in the same office.

Use the **C** key to change the number as needed; refer to page 23 for further details. When you are ready to dial, press the  key.

Edit: allows you to edit the Phonebook entry. Select **One Entry** to change one number in the selected name. If you change the name, the number is saved separately. Select **All Entry** to change the name of the entry.

Erase: allows you to erase the selected number and name from the phonebook. You are asked to confirm that you wish to erase the name and number by pressing the **Yes** soft key.

Copy: allows you to copy the selected number to another location. Use this option to store a number similar to one already in the memory; once copied, edit the number and store it in the phonebook.

Caller Group: allows you to assign the selected number to a caller group to set the phone to alert in a particular way when the person of the entry calls you. Select one of the 10 groups.

To remove entry from a group, select the **No Group** option.

For details about changing the caller group properties, see page 40.

Add Entry: allows you to add a new number in a different category (mobile, office, home or E-mail) to the currently selected name. A phonebook entry or name can contain up to four numbers, one in each category.

Searching for a Number in the Phonebook

After storing numbers in the Phonebook, you can search for them in two ways; by name and by caller group.

Searching for a Number by Name

1. When the idle screen is displayed, press the **Name** soft key.
2. Press the **Select** soft key when **Search** is highlighted. You are asked to enter a name.
3. Enter the first few letters of the entry name that you wish to find.

The phonebook entries are listed, starting with the first entry matching your input. This entry is also highlighted.

4. To...	Press the...
view the highlighted entry	View soft key.
select a different entry	— or — key until the required entry is highlighted.
look for a name starting with a different letter	key labelled with the required letter.

5. Find the required number under the name by pressing the — or — key.

6. Once you have found the required entry, press the  key to dial the number, or press the **Options** soft key to access the phonebook entry options; for further details, see page 36.

Searching a Number by Caller Group

1. When the idle screen is displayed, press the **Name** soft key.
2. Scroll to **Group Search** by pressing the — or — key and press the **Select** soft key. You are asked to enter a group name.
3. Enter the first few letters of the group name that you wish to find.

The caller groups are listed, starting with the first group matching your input. The group is also highlighted.





4. Scroll to the desired group by pressing the — or — key and press the **View** soft key.

The phonebook entries in the selected caller group are listed.

5. To...	Press the...
view the highlighted entry	View soft key.
select a different entry	— or — key until the required entry is highlighted.
look for a name starting with a different letter	key labelled with the required letter.

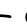
- Once you have found the required entry, press the  key to dial the number, or press the **Options** soft key to access the phonebook entry options; for further details, see page 36.

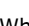
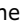
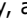
Editing a Caller Group

- When the idle screen is displayed, press the **Name** soft key.
- Scroll to **Group Edit** by pressing the  or  key and press the **Select** soft key.
- Scroll through the group list by pressing the  or  key.
- When the desired group is highlighted, press the **Options** soft key. The following options are available:
 - **Call ring tone:** allows you to select the ring melody to be used when you receive a voice call from a person in the group.
 - **SMS tone:** allows you to select the ring tone to be used when you received a text message from a person in the group.
 - **Graphic:** allows you to select the graphic icon to be displayed when you receive a voice call from a person in the group.
 - **Group Name:** allows you to assign a name to the group; for further details about how to enter characters, see page 43.
- Select the desired option by pressing the  or  key, followed the **Select** soft key, and change the setting.
- When you finish changing the settings, press the **C** or  key.

Speed-dialling

Once you have stored phone numbers in the phonebook, you can set up to 8 speed-dial entries and then dial them easily whenever you want, simply by pressing the associated number key.

Setting up Speed-dial Entries

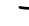
- When the idle screen is displayed, press the **Name** soft key.
- Scroll to **Speed Dial** by pressing the  or  key and press the **Select** soft key.
- Select one of the keys **2** to **9** to which you want to assign the speed-dialling feature and press the **OK** soft key.

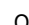
Note: If you have already assigned a number to the key, the **Options** soft key replaces the **OK** soft key. Go to Step 7.
- Enter the name of the phonebook entry you want to use and press the **OK** soft key.
- Select the required phonebook entry from the list and press the **View** soft key.
- Select the required number if the entry has more than one number, by pressing the  or  key and press the **Select** soft key.
- Once you have assigned a number to the selected key, four options are available:
 - **Change:** allows you to assign a different number to the key.
 - **Erase:** allows you to clear the setting so that no number is assigned to the key.

- **Erase All:** allows you to clear the settings for all keys so that no numbers are assigned to any of the keys.
 - **Number:** allows you to view the number assigned to the key.
8. When you finish setting up the speed-dial list, press the **C** or  key.



Speed-dialling from the Phonebook

To speed-dial the number in key locations 2 to 9, press and hold down the appropriate number key.

Note: Memory location 1 is reserved for your voice mail server number.

Checking Memory Status

You can check how many names and numbers are stored in the phonebook (card and phone memories) or how many free locations remain.

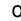
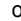
1. When the idle screen is displayed, press the **Name** soft key.
2. Scroll to the **Memory Status** option by pressing the  or  key and press the **Select** soft key.
3. Press the  or  key to view the number of existing and remaining entries in the card and phone memories.

Entering Text

When using your phone, you will often need to enter text. For example, when storing a name in the phonebook, creating your personal greeting or scheduling events in your calendar. You can enter alphanumeric characters by using your phone's keypad.

The following text input modes are available on your phone:

- **T9 mode**

This mode allows you to enter words with only one keystroke per letter. Each key on the keypad has more than one letter - when you press the **5** key once, J, K or L displays. The T9 mode automatically compares your keystrokes with an internal linguistic dictionary to determine the correct word, thus requiring far fewer keystrokes than the traditional upper/lower-case character modes.

- **Symbol mode**

This mode allows you to enter various symbols and special characters.

- **Upper/lower-case character modes**

These modes allow you to enter letters by pressing the key labelled with the required letter once, twice or three times until the letter displays.

- **Number mode**

This mode allows you to enter numbers.

Changing the Text Input Mode

When you are in a field that allows characters to be entered, you will notice the text input mode indicator on the display.

Example: Writing a message

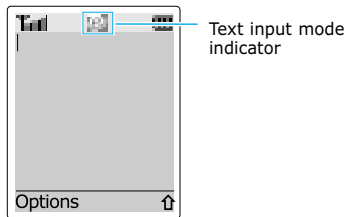

To select the...

T9 mode

Symbol mode

Upper-case character mode

Lower-case character mode

Number mode

Press the **↑** soft key until...

 displays.
See page 45.

 displays.
See page 46.

A displays.
See page 47.

a displays.
See page 47.

1 displays.
See page 48.

Using the T9 Mode

The T9 predictive text input mode allows you to key in any character using single keystrokes. This text input mode is based on a built-in dictionary.



1. When you are in the T9 predictive text input mode, start entering a word by pressing keys **2** to **9**. Press each key only once for one letter.

Example: to enter *HELLO* in the T9 mode, press , , ,  and .

The word what you are typing appears in the display. It may change with each key that you press.

2. Enter the whole word before editing or deleting the keystrokes.
3. If the word is correct, start entering the text word.

Otherwise, press **0**, **—** or **—** key repeatedly to display alternative word choices for the keys that you have pressed.

Example: both *OF* and *ME* have the sequence , . The phone displays the most commonly used choice first.

4. Complete each word with a space by pressing the  key.
 - To type words not found in the T9 mode, change the text input mode to the upper/lower-case character input mode.

- To enter full stops, hyphens or apostrophes, press the **1** key. The T9 mode applies grammar rules to ensure that the correct punctuation is used.

Example: **1** is used twice to display two punctuation marks:



- To shift the case in the T9 mode, use the ***** key.
- You can move the cursor by using the **(** and **)** keys. To delete letters, press the **←** key. Press and hold down the **↵** key to clear the display.

Using the Symbol Mode

The symbol mode enables you to insert symbols into a text message.

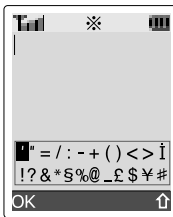

Use the navigation keys to scroll to the desired symbol and then press **OK** soft key to insert the highlighted symbol into your message.

Using the Upper/Lower-case Character Mode



use the **1** to **0** keys to enter your text.

- Press the keys labelled with the required letter:
 - Once for the first letter
 - Twice for the second letter
 - And so on
- Select the other letters in the same way.

Note: The cursor moves to the right when you press a different key. When entering the same letter twice or a different letter on the same key, just wait for a few seconds for the cursor to move right automatically, and then select the next letter.

Refer to the table below for more information about the characters available.

Key	Characters in the Order Displayed	
	Upper Case	Lower Case
1	Space . ! ? &	. % @ _ \$ &
2	A B C 2	a b c 2
3	D E F 3	d e f 3
4	G H I 4	g h i 4
5	J K L 5	j k l 5
6	M N O 6	m n o 6
7	P Q R S 7	p q r s 7
8	T U V 8	t u v 8
9	W X Y Z 9	w x y z 9
0	0 * # , ; ' " =	/ : - + () < >

- To insert a space, press the  key.
- You can move the cursor by using the (and) keys. To delete letters, press the  key. Press and hold down the  key to clear the display.

Using the Number Mode

The Number mode enables you to enter numbers into a text messages. Press the keys corresponding to the desired digits, and manually switch back to the text input mode of choice.

Options During a Call

Your phone provides a number of control functions that you can use during a call.

Putting a Call on Hold

You can place the current call on hold whenever you want. You can make another call while you have a call in progress if this service is supported by the network. Of these two calls, one is active and the other is on hold and you can switch between the calls.

To place a call on hold, simply press the **Hold** soft key. You can reactivate the call whenever you want, by pressing the **Unhold** soft key.

To make a call while you have a call in progress:

1. Key in the phone number that you wish to dial or look it up in the phonebook.
2. Press the  key to dial the second call.

The first call is automatically put on hold.

Or alternatively:

1. Put the current call on hold by pressing the **Hold** soft key.
2. Make the second call in the normal way.

To switch between the two calls, simply press the **Swap** soft key.

The current call is placed on hold and the call on hold is reactivated so that you can continue conversing with the other party.

When you want to finish the calls, end each call normally by pressing the  key.

Switching the Microphone Off (Mute)

You can temporarily switch your phone's microphone off, so that the other party cannot hear you.

Example: You wish to say something to another person in the room but do not want the other party to hear you.

To switch the microphone off temporarily:

1. Press the **Options** soft key.
2. If necessary, press the — key to highlight the **Mute** option.
3. Press the **OK** soft key. The other party can no longer hear you.

To switch the microphone back on:

1. Press the **Options** soft key.
2. If necessary, press the — key to highlight the **Unmute** option.
3. Press the **OK** soft key. The other party can hear you again.

Muting/Sending Key Tones

These options allow you to turn the key tones off or on. If the **Mute keys** option is selected, your phone does not transmit the key tones. It allows you to press keys without hearing annoying key tones during a call.

Note: To communicate with answering machines or computerised telephony systems, the **Send keys** option must be selected.

Searching for a Number in the Phonebook

You can search for a number in the phonebook during a call.

1. Press the **Options** soft key.
2. Press the — key to highlight the **Phonebook** option.
3. Press the **OK** soft key.

The phonebook entries are listed.

4. Enter the name that you wish to find.

If you enter the first few letters of the name, all phonebook entries are listed, starting with the first entry matching your input. The entry is also highlighted.

5. To view the highlighted entry, press the **View** soft key.

For a more detailed description about the Phonebook feature, refer to page 34.

Using the SMS Service

If you receive an SMS (Short Message Service) message during a call, the message icon (✉) flashes on the display. The **SMS Service** option enables you to use this feature.

Read Messages: allows you to read the messages that you received.



Write Messages: allows you to write a message.

For further details about the SMS service, refer to page 61.

Answering a Second Call

You can answer an incoming call while you have a call in progress, if this service is supported by the network and you set the **Call Waiting** menu option (**Menu 6.3**) to **Activate** (see page 101). You will be notified of an incoming call by a call waiting tone.

To answer a call while you have a call in progress:

1. Press the  key to answer the incoming call. The first call is automatically put on hold.
2. To switch between the two calls, press the **Swap** soft key.
To end a call on hold, press the **Options** soft key and select the **End Held Call** option.
3. To end the current call, press the  key.

Making a Multiparty Call



A multiparty call is a network service that allows up to six people to take part simultaneously in a multiparty or conference call. For more information, contact your service provider.

Setting up the Multiparty Call

1. Call the first participant in the normal way.
2. Call the second participant in the normal way. The first call is automatically put on hold.
3. To join the first participant to the multiparty call, press the **Options** soft key and select the **Join** option.
4. To add a new person to the multiparty call, call the person in the normal way, then press the **Options** soft key and select the **Join** option.

You can add incoming callers by answering the call and pressing Options, followed by Join. Repeat as needed.

Having a Private Conversation With One Participant

1. Press the **Options** soft key and choose the **Select one** option.
The list of call participants appears.
2. Highlight the required person, by pressing the  or  key, followed by the **Select** soft key or the  key.

3. Select the **Private** option.

Now you can talk privately with that person. The other participants can continue to converse with each other.

4. To return to the multiparty call, press the **Options** soft key and select the **Join** option.

All the multiparty call participants can now hear each other.

Dropping One Participant

1. Press the **Options** soft key and choose the **Select one** option.

The list of call participants appears.

2. Highlight the required person, by pressing the **←** or **→** key, followed by the **Select** soft key or the **↶** key.

3. Select **Remove**.

The call is ended with that participant, but you can continue to talk with the other participants.

4. End the multiparty call by closing the folder or pressing the **Ⓜ** key.

Using the Menus

The phone offers a range of functions that allow you to tailor the phone to your needs. These functions are arranged in menus and sub-menus.



The menus and sub-menus can be accessed by scrolling with the navigation keys or by using the shortcuts.

Accessing Menu Functions by Scrolling

1. In idle mode, press the **Menu** soft key to access menu mode.
2. Scroll with the **←** and **→** keys to reach the required main menu, **Phone Settings** for example. Press the **Select** soft key or the **)** key to enter the menu.
3. If the menu contains any sub-menus, **Language** for example, you can access them by scrolling with the **←** and **→** keys and pressing the **Select** soft key.

If the menu that you have selected contains further options, repeat the same procedure.

4. To...	Press the...
scroll through the menus	← or → key or use the ▲ and ▼ keys on the left side of the phone.
confirm the chosen setting	Select soft key or the (key.

To...	Press the...
return to the previous menu level	 soft key or the (key.
exit the menu without changing the settings	 key.

Accessing Menu Functions by Using Shortcuts

The menu items, such as menu, sub-menus and options, are numbered and can be accessed quickly, using their shortcut number. The shortcut number is shown at the bottom right next to the  soft key on the display. Simply press the **Menu** soft key and key in the required number.

Example: Accessing the **Language** option.

1. Press the **Menu** soft key.
2. Press the **4** key for **Phone Settings**.
3. Press the **5** key for **Language**.

The languages available are displayed directly.

Note: The numbers assigned to each menu option are indicated in the list on page 57. They may not match the menu number on the phone. It depends on the services supported by the SIM card.

List of Menu Functions

The following illustration shows the menu structure available and indicates the:

- Number assigned to each option.
- Page on which you can find a description of each feature.

Note: If you use a SIM AT card that provides additional services, the **SIM AT (8)** menu is displayed first when you press the **Menu** soft key to enter menu mode. For further details, refer to your SIM card user's guide.

1. Messages (see page 61)

- 1.1 Read Messages
 - 1.1.1 Inbox
 - 1.1.2 Outbox
- 1.2 Write Messages
- 1.3 Templates
- 1.4 Setup
 - 1.4.1 Setting 1*
 - 1.4.2 Setting 2*
 - 1.4.3 Common Setting
- 1.5 Broadcast
 - 1.5.1 Read
 - 1.5.2 Receive
 - 1.5.3 Channel List
 - 1.5.4 Language
- 1.6 Voice Mail
 - 1.6.1 Connect to Voice Server
 - 1.6.2 Voice Server
- 1.7 My Contents
 - 1.7.1 My Melody
 - 1.7.2 My Picture
 - 1.7.3 My Animation

* Shown only if supported by your SIM card.

1. Messages *(continued)*

- 1.8 Memory Status
 - 1.8.1 SIM memory
 - 1.8.2 PHONE memory
 - 1.8.3 CB memory

2. Call Records *(see page 69)*

- 2.1 Missed Calls
- 2.2 Received Calls
- 2.3 Dialed Calls
- 2.4 Call Time
 - 2.4.1 Last Call Time
 - 2.4.2 Total Sent
 - 2.4.3 Total Received
 - 2.4.4 Reset Timers
- 2.5 Call Cost*
 - 2.5.1 Last Call Cost
 - 2.5.2 Total Cost
 - 2.5.3 Max Cost
 - 2.5.4 Reset Counters
 - 2.5.5 Set Max Cost
 - 2.5.6 Price/Unit

3. Sound Settings *(see page 72)*

- 3.1 Ring Tone
- 3.2 Ring Volume
- 3.3 Alert Type
- 3.4 Keypad Tone
- 3.5 Message Tone
 - 3.5.1 SMS Tone
 - 3.5.2 SMS-CB Tone
- 3.6 AutoFolder Tone
- 3.7 Extra Tones
 - 3.7.1 Error Tone
 - 3.7.2 Minute Minder
 - 3.7.3 Connect Tone

4. Phone Settings *(see page 76)*

- 4.1 Infrared Activate
- 4.2 My Settings
 - 4.2.1 Wallpaper
 - 4.2.2 Colour Theme
 - 4.2.3 Menu Style
- 4.3 Greeting Message
- 4.4 Own Number
- 4.5 Language
- 4.6 Security
 - 4.6.1 PIN Check
 - 4.6.2 Change PIN
 - 4.6.3 Phone Lock
 - 4.6.4 Change Password
 - 4.6.5 SIM Lock
 - 4.6.6 FDN Mode*
 - 4.6.7 Change PIN2*
- 4.7 LCD Settings
 - 4.7.1 Contrast
 - 4.7.2 Back Light
 - 4.7.3 Auto Light
 - 4.7.4 Graphic Logo
- 4.8 Extra Settings
 - 4.8.1 Auto Redial
 - 4.8.2 Active Folder
 - 4.8.3 Anykey Answer
 - 4.8.4 Auto Folder
- 4.9 Short Cut
- 4.10 Reset Settings

5. Organiser *(see page 88)*

- 5.1 Calendar
- 5.2 To Do List
- 5.3 Time & Date
 - 5.3.1 Set Time
 - 5.3.2 Set Date
 - 5.3.3 World Time
 - 5.3.4 Time Format
- 5.4 Alarm
- 5.5 Calculator
- 5.6 Currency Exchange

* Shown only if supported by your SIM card.

* Shown only if supported by your SIM card.

6. Network Services (see page 97)

- 6.1 Call Diverting
 - 6.1.1 Divert Always
 - 6.1.2 Busy
 - 6.1.3 No Reply
 - 6.1.4 Unreachable
 - 6.1.5 Cancel All
- 6.2 Call Barring
 - 6.2.1 All Outgoing
 - 6.2.2 International
 - 6.2.3 International Except to Home
 - 6.2.4 All Incoming
 - 6.2.5 Incoming While Abroad
 - 6.2.6 Cancel All
 - 6.2.7 Change Barring Password
- 6.3 Call Waiting
 - 6.3.1 Voice Calls
 - 6.3.2 Cancel All
- 6.4 Network Selection
 - 6.4.1 Automatic
 - 6.4.2 Manual
- 6.5 Caller ID
 - 6.5.1 Default
 - 6.5.2 Hide Number
 - 6.5.3 Send Number
- 6.6 Closed User Group
 - 6.6.1 Index List
 - 6.6.2 Outside Access
 - 6.6.3 Default Group
 - 6.6.4 Deactivate*

7. Fun Box (see page 105)

- 7.1 Games
- 7.2 WAP Browser
- 7.3 Downloads
 - 7.3.1 Sounds
 - 7.3.2 Pictures

* Shown only if the Closed User Group Feature is active.

Messages

The SMS (Short Message Service) function is a network service and may not be supported by your network. Messages can be sent by text, fax, Email and paging messaging systems, provided that these services are supported by your network. To send text messages by phone, you must obtain the number of the SMS centre from your service provider.

When the message icon (✉) appears, you have received new text messages. If the message memory is full, an error message is displayed and you cannot receive any new messages. Use the **Delete** option in the **Read Messages** menu (**Menu 1.1**) to delete obsolete messages.

Read Messages (Menu 1.1)

Two message boxes are available:

Inbox: used to store the messages that you received.

Outbox: used to store the messages that you already sent or will send.

Reading a Message

1. Select the required box and press the **Select** soft key.

The list of messages in the box is displayed by the sender or recipient's phone number or name if it is available in your phonebook.

2. Select the required message and press the **View** soft key to view the message contents.
3. To scroll through the message, press the **←** or **→** key.

While reading a message, you can choose the following options by pressing the **Options** soft key.

Delete: allows you to delete obsolete messages.

Text Reply (Inbox only): allows you to reply to the sender by sending a text message. You can also change the SMS centre number, if required.

Call Back (Inbox only): allows you to call the sender back.

Cut Number: allows you to extract a number from the message text, so that you can call the number or save it in the phonebook.

Send: allows you to send a message that you have received or saved. For further information for sending a message, see below.

Edit Message: allows you to edit a message.

Select Objects: allows you to save the items, such as sounds or images, from the message into your phone. You can use the items when writing a message; for details, see below.

Note: The options available vary, depending on the message status; new/old, not sent or sent for example.

Write Messages *(Menu 1.2)*

In this menu, you can write and send a text message.

Note: If you add items to the message, the number of the characters you can enter will be decreased.

1. Create a message.

Note: For more information about entering characters, refer to page 43.

2. If you press the **Options** soft key while entering a message text, the following options are available.

- **Send Only:** allows you to send the message. The message will be deleted after sending.

- **Save and Send:** allows you to save a copy of the message and then send the message to the required destination. You can read the message in your outbox using the **Read Messages** option.

- **Save Only:** allows you to save the message so that it can be sent later. You can read the message in your outbox using the **Read Messages** option.

- **Add Objects:** allows you to add the sounds, pictures, or animations to the message. Select the category of the object to be added; **Sound, Picture, Animation and My Contents** are available. In each category, you can select the various factory-set items or choose an item received from other sources, such as the Internet or other phones.

- **Add Templates:** allows you to apply one of the preset message templates to the text. Select one of the five messages predefined via the **Templates** menu option (**Menu 1.3**); for further details, see page 64.

3. When you finish entering your message, press the **Options** soft key and select **Send Only** or **Save and Send**.

If you want just to save the message, select **Save Only**.

4. Enter the destination number.

Pressing the **Name** soft key when it is displayed allows you to search the Phonebook for a number.

5. Press the **OK** soft key. The message is sent.

Templates *(Menu 1.3)*

Using this menu, you can preset up to five messages that you use most frequently. Scroll through the template list using the **←** and **→** keys. When the desired message cell is highlighted, press the **Options** soft key.

Edit: allows you to write a new message or edit the selected message.

Note: For further information about how to enter characters, refer to page 43.

Send Message: allows you to recall the selected message. Once you have completed the message, you can send, save and send or simply save it. For details about sending a message, see page 62.

Delete: allows you to delete the selected message. You are asked to confirm the deletion by pressing the **Yes** soft key.

Setup *(Menu 1.4)*

In this menu, you can set up default SMS information. A setting group is a collection of settings required to send messages. The number of setting groups available depends on the capacity of your SIM card. The setting group you last accessed is automatically activated for message transmission and you can see a check mark in front of it.

Setting x (where **x** is the setting group number): each group has its own sub-menu.

Service Centre: allows you to store or change the number of your SMS centre required when sending messages. You must obtain this number from your service provider.

Default Type: allows you to set the default message type (Text, Fax, Email and Paging). The network can convert the messages into the selected format.

Default Validity: allows you to set the length of time for which your text messages will be stored at the message centre while attempts are made to deliver them.

Setting Name: allows you to give a name to the setting group currently being defined.

Common Setting: the following options are available.

Reply Path: allows the recipient of your SMS message to send you a reply message via your message centre, if the service is provided by the network.

Delivery Reports: allows you to activate or deactivate the report function. When this function is activated, the network informs you whether your message has been delivered or not.

Broadcast *(Menu 1.5)*

This network service allows you to receive text messages on various topics, such as the weather or traffic. Messages are displayed immediately as they are received, provided that:

- the phone is in idle mode.
- the **Receive** option is set to **Enable**.
- the message channel is currently active in the channel list.

The following options are available:

Read: lets you view the message. **Volatile** displays the messages from the network, but loses its contents as soon as the phone is switched off. Scroll through the message by using the **←** and **→** keys. While reading a message, press the **Save** soft key to store it into the **Archive** box for later retrieval.

Receive: allows you to enable or disable the reception of broadcast messages.

Channel List: allows you to indicate the channels from which you wish to receive broadcast messages. The following options are available.

Select: used to enable or disable channels in the list by marking or unmarking them respectively (a check mark is displayed in front of each channel selected).

Add Channel: used to declare the ID and title for a new channel.

Delete: used to remove a channel from the list.

Edit: used to change the ID and title of an existing channel.

Language: allows you to select your preferred language to be used when displaying cell broadcast messages.

Please contact your service provider for more information.

Voice Mail *(Menu 1.6)*

This menu provides you with a way of accessing your voice mailbox, if provided by your network. The following options are available.

Connect to Voice Server: before using this feature, you must enter the voice server number obtained from your service provider (see menu option **1.6.2**). You can then select this option and simply press the **OK** soft key to listen to your messages.

You can quickly connect to the voice server by pressing and holding the **1** key down in idle mode.

Voice Server: allows you to change the voice mail server number, if necessary.

To...	Press the...
enter the server number	corresponding numeric keys.
correct a digit	C key.
move the cursor to the left/right clearing without the digit	(← or →) key.
save the number	OK key.

Note: Voice Mail is a network feature. Please contact your service provider for more information.

My Contents *(Menu 1.7)*

After saving the items from the received messages into your phone memory by using the **Select Object** option (see page 62), you can see them in this menu.

To delete the objects in this menu, press the **Delete** soft key.
You can forward the items to other people by including message and/or use them for your ring tone or background image.

Three categories of objects are available:

- **My Melody**
- **My Picture**
- **My Animation**

Memory Status *(Menu 1.8)*

This menu shows how many messages are currently stored in the SIM, phone and CB memories.

Call Records

In this menu, you can view the:

- phone calls missed, received or dialled.
- length of the calls you made or received.
- cost of the calls you made.

Note: You can access all numbers in the three call records by pressing the  key in idle mode.

Missed Calls *(Menu 2.1)*

This option lets you view the last 20 unanswered calls.

The number and name, if available, are displayed, together with the date and time when the call was received. Press the  key to dial the number.

By pressing the **Options** soft key, you can:

- Delete the call from the list.
- Edit the number if available and dial it or save it in the phonebook.

Received Calls *(Menu 2.2)*

This option lets you view the last 20 received calls.

The number and name, if available, are displayed, together with the date and time when the call was received. Press the  key to dial the number.

By pressing the **Options** soft key, you can:

- Delete the call from the list.
- Edit the number if available and dial it or save it in the phonebook.

Dialled Calls *(Menu 2.3)*

This option lets you view the last 20 dialled calls.

The number and name, if available, are displayed, together with the date and time when the call was made. Press the  key to dial the number.

By pressing the **Options** soft key, you can:

- Delete the number.
- Edit the number and dial it or save it in the phonebook.

Call Time *(Menu 2.4)*

This option lets you view the timers for calls made and received.

The following timers are available:

Last Call Time: length of the last call.

Total Sent: total length of all calls made since the timer was last reset.

Total Received: total length of all calls received since the timer was last reset.

Reset Timers: option used to reset the call timers; you must first enter the phone password (see page 116) and then press the **OK** soft key.

Note: The actual time invoiced for calls by your service provider may vary, depending on network features, rounding-off for billing purposes and so forth.

Call Cost* *(Menu 2.5)*

This network feature lets you view the cost of calls.

The following options are available:

Last Call Cost: cost of the last call made.

Total Cost: total cost of all calls made since the cost counter was last reset. If the total cost exceeds the maximum cost set via the **Set Max Cost** option, you can no longer make any calls until you reset the counter.

Max Cost: maximum cost set via the **Set Max Cost** option (see below).

Reset Counters: option used to reset the cost counter; you must first enter your PIN2 (see page 118) and then press the **OK** soft key.

Set Max Cost: option used to enter the maximum cost that you authorise for your calls.

Price/Unit: option used to set the cost of one unit; this price per unit is applied when calculating the cost of your calls.

* Shown only if supported by your SIM card.

Sound Settings

You can use the **Sound Settings** menu to customise various settings, such as the:

- Ring melody, volume and type.
- Sounds made when you press a key, make an error or receive a message.

Note: When the phone is in the silent mode (see page 29), you cannot change the sound settings.

Ring Tone *(Menu 3.1)*

This option allows you to select the required ring melody.

You can choose between many different melodies. Each time you select a melody, it is played for a few seconds. If you have downloaded any sounds from the Internet or EasyLink program or received any ring tone message, you can view the list in this menu.

Ring Volume *(Menu 3.2)*

This option allows you to adjust the ring volume to one of five levels.

Use the **←** and **→** keys or the **▲** and **▼** keys on the left side of the phone.

Alert Type *(Menu 3.3)*

This option allows you to specify how you are to be informed of any incoming calls.

The following options are available:

Melody: the phone rings using the ring melody or bell selected via the **Ring Tone** menu option; see page 72.

Vibration: the phone vibrates but does not ring.

Vibra+Melody: the phone first vibrates three times and then starts ringing.

Keypad Tone *(Menu 3.4)*

This option allows you to select the tone that the keypad generates when you press a key.

The following options are available:

OFF: the keys do not make any sound.

Tone: each key, when pressed, makes a different sound.

Beep: each key, when pressed, makes the same sound.

Message Tone *(Menu 3.5)*

This option allows you to select how the phone informs you that a new message has been received.

SMS Tone

This option allows you to select how the phone informs you that a new SMS message has been received.

The following options are available:

OFF: the phone does not use the SMS tone.

Vibration: the phone vibrates.

SMS Tone1~10: the phone uses an SMS tone. You are provided with ten SMS tones.

SMS-CB Tone

This option allows you to select how the phone informs you that a new cell broadcast (CB) message has been received.

The following options are available:

OFF: the phone does not use the CB tone.

Vibration: the phone vibrates.

SMS-CB Tone1~10: the phone uses a CB tone. You are provided with ten CB tones.

AutoFolder Tone *(Menu 3.6)*

Using this option, you can set whether the phone sounds a tone when you open the folder by pressing the key on the right side of the phone.

The following options are available:

OFF: the phone does not use any tone.

Folder Tone1~5: the phone uses a tone. You are provided with five tones.

Extra Tones *(Menu 3.7)*

You can turn the several tones to inform you of some conditions on or off.

To turn a given tone...	Press the...
On	ON soft key. A check mark is displayed in front of the option.
Off	OFF soft key. The check mark is no longer displayed.

The following options are available:

Error Tone: sets whether the phone informs you that you have made a mistake or not.

Minute Minder: sets whether the phone must beep every minute during an outgoing call to keep you informed of the length of your call.

Connect Tone: sets your phone to beep when the person you are calling answers.

Phone Settings

Many different features of your phone can be customised to suit your preferences. All of these features are accessed via the **Phone Settings** menu.

Infrared Activate *(Menu 4.1)*

This feature allows you to send or receive data/fax through the infrared port. To use and infrared connection, you must:

- Configure and activate an IrDA-compliant infrared port on your PC.
- Activate the infrared feature on the phone; the IrDA icon () appears on the top line of the display.
- Align the IrDA port on the phone with the IrDA port on your computer.

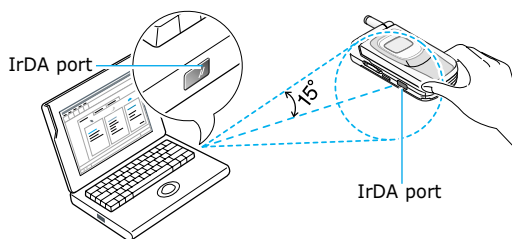

The connection is ready for data transmission.

If there is no communication between your phone and the IrDA-compliant device within 30 seconds of activating the feature, it is automatically deactivated.

My Settings *(Menu 4.2)*

You can change the background image and the colour of the components in the display according to your preference.

Wallpaper

This option allows you to change the background image (wallpaper) to be displayed in idle mode.

To change the background image:

1. Scroll through the list by pressing the **←** or **→** key.

You have various preset images available. You can also select the blank background and any images downloaded from the Internet or EasyLink program.

2. Press the **View** soft key when the desired image is highlighted.
3. Press the **Select** soft key to set the image to display it on the idle screen.

Colour Theme

You can change the colour setting of the display components, such as text, soft key display area or the menu names and icons. Five different colour settings are available.

Select the required setting and press the **Select** soft key, followed by **OK** to confirm the highlight colour and colour theme.

Menu Style

This option allows you to select the menu display style. You can choose between **Folder Style** and **Nature Style**.

Greeting Message *(Menu 4.3)*

This option allows you to set a greeting message to be displayed briefly when the phone is switched on. When you select this menu, the current message is displayed.

To...	Press the...
clear the existing message	C key and hold it down until the display is cleared.
enter a new message	Appropriate alphanumeric keys.
change the text input mode	right soft key, labelled with the current input mode.
save the new message	OK soft key.

For further details about how to enter characters, refer to page 43.

Own Number *(Menu 4.4)*

This feature allows you to:

- Assign a name to each of your own phone numbers registered on your SIM card.
- Edit the names and numbers.

This function is a memory aid, which you can use to check your own phone numbers, if you need to do so.

Any changes made here do not in any way affect the actual subscriber numbers on your SIM card.

Language *(Menu 4.5)*

You can choose a language from **English**, **Indonesia** and **Malaysia**. The phone may display English only depending on your country.

Security *(Menu 4.6)*

The Security feature enables you to restrict the use of your phone to:

- The people of your choice
- The types of calls of your choice

Various codes and passwords are used to protect the features of your phone. They are described in the following sections (see also pages 116-119).

PIN Check

When the PIN Check feature is enabled, you must enter your PIN each time you switch the phone on. Consequently, any person who does not have your PIN cannot use your phone without your approval.

Note: Before disabling the PIN Check feature, you must enter your PIN.

To change your PIN, refer to the **Change PIN** menu option (**Menu 4.6.2**) below.

The following options are available:

Enable: you must enter the PIN each time the phone is switched on.

Disable: the phone connects directly to the network when you switch it on.

Change PIN

This feature allows you to change your current PIN to a new one, provided that the PIN Check feature is enabled. You must enter the current PIN before you can specify a new one.

Once you have entered a new PIN, you are asked to confirm it by entering it again.

Phone Lock

When the Phone Lock feature is enabled, the phone is locked and you must enter the 8-digit phone password each time the phone is switched on.

The password is factory set to "00000000." To change the phone password, refer to the **Change Password** menu option (**Menu 4.6.4**) on the following page.

Once the correct password has been entered, you can use the phone until you switch it off.

The following options are available:

Enable: you are required to enter the phone password when you switch the phone on.

Disable: you are not asked to enter the phone password when you switch the phone on.

Change Password

The Change Password feature allows you to change your current phone password to a new one. You must enter the current password before you can specify a new one.

The password is factory set to "00000000." Once you have entered a new password, you are asked to confirm it by entering it again.

SIM Lock

When the SIM Lock feature is enabled, your phone only works with the current SIM. You must enter the SIM lock code.

Once you have entered the lock code, you are asked to confirm it by entering it again.

To unlock the SIM, you must enter the SIM lock code.

FDN Mode

The FDN (Fixed Dial Number) mode, if supported by your SIM card, allows you to restrict your outgoing calls to a limited set of phone numbers.

The following options are available:

Disable: you can phone any number.

Enable: you can only call phone numbers stored in the phonebook. You must enter your PIN2.

Note: Not all SIM cards have a PIN2. If your SIM card does not, this menu option is not displayed.

To change your PIN2, refer to the **Change PIN2** menu option (**Menu 4.6.7**) below.

Change PIN2

The Change PIN2 feature allows you to change your current PIN2 to a new one. You must enter the current PIN2 before you can specify a new one.

Once you have entered a new PIN2, you are asked to confirm it by entering it again.

Note: Not all SIM cards have a PIN2. If your SIM card does not, this menu option is not displayed.

LCD Settings *(Menu 4.7)*

Contrast

This option allows you to adjust the contrast of each display screen to make them lighter or darker.

To adjust the display contrast:

1. Select the required display **Main LCD** or **Front LCD**, and press the **Select** soft key.

2. Adjust the brightness using the **—** and **—** keys or the **▲** and **▼** keys on the left side of the phone.

3. When you are satisfied, press the **OK** soft key to save the selection.

Back Light

You can select whether or not the phone uses the backlight. A marginal increase in standby/talk time can be achieved by turning the backlight off.

The following options are available:

OFF: the backlight is not used.

Short: the backlight comes on when you press a key or receive a call and switches off 10 seconds after the last key is pressed.

Long: the backlight comes on when you press a key or receive a call and switches off 20 seconds after the last key is pressed.

Auto Light

Using this feature, you can specify the time for which the backlight is to be used. This feature is helpful for conserving your battery power.

The following options are available:

Disable: the backlight is used according to the setting in the **Back Light** menu option (**Menu 4.7.2**); see above.

Enable: the backlight is used only during the specified period of time. Set the required length of time in hours and minutes, using the appropriate number keys.

Graphic Logo

This option allows you to display your operator's logo instead of its name.

Off: the operator name is displayed in idle mode.

On: the operator logo stored in your phone is displayed in idle mode; if no logo has been stored, the operator name is displayed.

Extra Settings *(Menu 4.8)*

You can turn the functions for automatic redialling or answering on or off.



To turn a given tone...	Press the...
On	ON soft key. A check mark is displayed in front of the option.
Off	OFF soft key. The check mark is no longer displayed.

The following options are available:

Auto Redial: when this option is checked, the phone makes up to ten attempts to redial a phone number after an unsuccessful call.

Note: The interval between two call attempts varies.

Active Folder: when this option is checked, you can simply open the folder to answer a call. When it is unchecked, you must open the folder and press a key, depending on the setting of the **Anykey Answer** option (see below).

Anykey Answer: when this option is checked, you can answer an incoming call by pressing any key, except the  key and the **Reject** soft key. To reject the call, press the  key or the **Reject** soft key.

When it is unchecked, you can only press the  key or **Accept** soft key.

Auto Folder: when this option is checked, you can easily open and close the folder by pressing the key on the right side of the phone.









Notes:

- Using the Auto Folder feature drains your battery power, so that you will have less talk time and standby time.
- When the battery is low, the auto folder key may not function. You need to manually open or close the folder.
- Do not disturb the folder while it is automatically opening or closing. This may cause damage to the motor.

Short Cut *(Menu 4.9)*

The navigation keys can be used as shortcut keys. In idle mode, they allow you to access the specific menu options directly.

To assign a shortcut to a key:

1. Select the key to be used as a shortcut key by pressing the  or  key.
 - **Key up** ()
 - **Key down** ()
 - **Key right** ()
 - **Key left** ()
2. Select the menu option to be assigned to the key by pressing the  or  key.

Note: To deactivate a shortcut key, select the **None** option.

3. Press the **Select** soft key to save the selection.

Reset Settings *(Menu 4.10)*

You can easily reset your phone to its default configuration.

1. Select the **Reset Settings** menu option.
2. Enter the 8-digit phone password and press the **OK** soft key.

Note: The password is preset to "00000000." To change this password, refer to page 81.

Organiser

The Organiser feature enables you to:

- View the calendar and organise your schedule.
- Define a list of things to do.
- Set the current date and time.
- Set the alarm so that the phone rings at a specific time (to remind you of an appointment for example).
- Use the phone as a calculator for basic mathematical equations or currency exchange operations.

Calendar *(Menu 5.1)*

With the Calendar feature, you can:

- Consult the calendar.
- Write memos to keep track of your schedule and trigger an alarm, if necessary.

Consulting the Calendar

When you select the **Calendar** menu option (**Menu 5.1**), the calendar is displayed. The following options are available when you press the **Options** soft key.

Search all: displays all memos set, regardless of the day and starting with the oldest. To scroll through the memos, press the **←** or **→** key.

Delete all: allows you to delete all memos. You are asked to confirm your action.

Go to date: allows you to jump to a specific date.

Exit: exits the Calendar feature and returns to the idle mode.

Writing a Memo

To write or edit a memo on a specific date:

1. Select the required date in the calendar, using the navigation keys.

Note: To skip to the previous or next month, press the **▲** and **▼** keys on the left side of the phone.

2. Press the **Select** soft key.

An empty memo screen is displayed to allow you to enter your memo.

3. Enter your memo and then press the **OK** soft key.

Note: For further details about how to enter characters, refer to page 43.

You are asked if you wish to set an alarm.

4. To set an alarm to ring on the chosen day, press the **Yes** soft key. Otherwise, press the **No** soft key.
5. If you pressed the **Yes** soft key, set the time for the alarm and press the **OK** soft key. The colour of the date on the calendar is changed to green to indicate that a memo exists.

Editing a Memo

If you select a day for which a memo already exists, you can press the **Edit** soft key to edit the displayed memo.

Note: For further details about how to enter characters, refer to page 43.

Once you have finished editing the memo, press the **OK** soft key. The following options are then available when you press the **Options** soft key.

Alarm: allows you to set the alarm to ring on the chosen day.

Erase: allows you to delete the memo.

Copy to: allows you to copy the memo to another date and/or time.

Move to: allows you to change the date and/or time of the memo.

To Do List *(Menu 5.2)*

This feature allows you to:

- Draw up a list of tasks to be done.
- Assign a priority and deadline to each task.
- Sort the tasks by priority and status mark.



Creating the To Do List

1. Press the **New** soft key.
2. Enter the first task.

Note: For further details about how to enter characters, see page 43.
3. Press the **Select** soft key.
4. Select high, normal or low priority using the **—** and **—** keys and press the **Select** soft key.
5. Enter your deadline and press the **OK** soft key.

If you do not want to set deadline, press the **Skip** soft key.

Editing the To Do List

If tasks are already defined in the To Do List when you select the **To Do List** menu option (**Menu 5.2**), the current contents are displayed with a status check mark and priority;  for high,  for normal or  for low.

The following options are available:

To...	Then...
view the details for a specific task	<ul style="list-style-type: none"> • Highlight the task. • Press the View soft key.
change the status of a specific task	<ul style="list-style-type: none"> • Highlight the task. • Press the * key to mark the task as completed as of the current date and time. <p>or</p> <ul style="list-style-type: none"> • Highlight the task. • Press the Options soft key. • Select the Mark option. • Select the appropriate status from Done and Undo.
create a new task	<ul style="list-style-type: none"> • Press the Options soft key. • Select the New option. • Enter the text, priority and deadline for the task.
edit an existing task	<ul style="list-style-type: none"> • Highlight the task. • Press the Options soft key. • Select the Edit option. • Change the text, priority and deadline for the task.

To...	Then...
sort the existing tasks by priority or status	<ul style="list-style-type: none"> • Press the Options soft key. • Select the Sort option. • Select the sort criterion from High, Low, Done and Undo.
copy a task	<ul style="list-style-type: none"> • Highlight the task. • Press the Options soft key. • Select the Copy option. • Change the text, priority and deadline for the task as needed.
copy a task to the calendar	<ul style="list-style-type: none"> • Highlight the task. • Press the Options soft key. • Select the Copy to calendar option. • Change the text and deadline for the task and set alarm as needed.
delete a task	<ul style="list-style-type: none"> • Highlight the task. • Press the Options soft key. • Select the Delete option.
delete all tasks	<ul style="list-style-type: none"> • Press the Options soft key. • Select the Delete all option. • Confirm the deletion by pressing the OK soft key.

Time & Date *(Menu 5.3)*

This option allows you to change the current time and date displayed. You can also check the current time for Greenwich Mean Time (GMT) and 21 major cities around the world.

The following options are available:

Set Time: allows you to enter the current time. You can choose the time format via the **Time Format** menu option (**Menu 5.3.4**).

Note: Before setting the time, you must specify your time zone, via the **World Time** menu option (**Menu 5.3.3**).

Set Date: allows you to enter the day, month and year.

World Time: allows you to check the current time for Greenwich Mean Time (GMT) and 21 major cities around the world, using the (and) keys.

The screen shows the:

- City name.
- Current date and time.
- Time difference between the selected city and your city if you have set the local time (see below for further details) or GMT (by default).

To select your time zone:

1. Select the city corresponding to your time zone by pressing the (or) key one or more times.
The local date and time are displayed.
2. Press the **Set** soft key.

Time Format: allows you to change the time format to **24 Hours** or **12 Hours**.

Alarm *(Menu 5.4)*

This feature allows you to:

- Set an alarm to ring at a specific time.
- Set the phone to switch on automatically and ring the alarm even if the phone is switched off (the **Auto Power** menu option set to **Enable**).

The following options are available:

Once Alarm: the alarm rings only once and is then deactivated.

Daily Alarm: the alarm rings every day at the same time.

Morning Call: the alarm rings to wake you up in the morning.

To set the alarm:

1. Choose the type of the alarm to be set.
2. Enter the required time and press the **OK** soft key.
3. If you select **Morning Call** in step 1, select **Monday to Friday** or **Monday to Saturday** and press the **OK** soft key.

Remove Alarm: deactivates all alarm settings.

Auto Power: when this option is set to **Enable**, the phone will automatically turn on at the specified time and the alarm will ring.

If this menu option is set to **Disable** and the phone is switched off at the specified time, the alarm will not ring.

To stop the alarm when it rings, open the folder and press the **Exit** soft key.

While setting or viewing an alarm, the following options are available when you press the **Options** soft key.

Remove Alarm: deactivates the current alarm.

Alarm Sound Set: allows you to select the alarm melody.

Calculator *(Menu 5.5)*

Using this feature, you can use the phone as a calculator. The calculator provides the basic arithmetic functions; addition, subtraction, multiplication and division.

Using the Calculator

1. Enter the first number using the numeric keys.
2. Press the right soft key until the required arithmetic symbol appears: **+** (add), **-** (subtract), ***** (multiply), **/** (divide).
3. Enter the second number.
4. Repeat Steps 2 to 3 as many times as needed.

Notes:

- To erase any mistakes and clear the display, press the **C** key.
 - To include a decimal point or a bracket, press the left soft key until the required symbol is displayed.
5. To get the result, press the  key.

Currency Exchange *(Menu 5.6)*

Using this menu option, you can make currency conversions.

1. Enter the current exchange rate of your source currency and press the **OK** soft key.

You can insert a decimal point by pressing the **#** key.

2. Enter the amount for which you want to conduct the currency conversion and press the **OK** soft key.

The exchange rate and equivalent value are displayed.

3. Press the **Exit** soft key to exit the currency convertor.

Network Services

These menu functions are network services. Please contact your service provider to check their availability and subscribe to them, if you wish.

Call Diverting *(Menu 6.1)*

This network service enables incoming calls to be rerouted to the number that you specify.

Example: You may wish to divert your business calls to a colleague while you are on holiday.

Call diverting can be set up in the following ways:

Divert Always: all calls are diverted.

Busy: calls are diverted if you are already making another call.

No Reply: calls are diverted if you do not answer.

Unreachable: calls are diverted if you are not in an area covered by your service provider.

Cancel All: all call diverting options are cancelled.

You can specify individual diverting options for each of the following call types:

- Voice calls only
- Fax calls only
- Data calls only

Example: You can:

- Systematically divert fax calls to your office fax machine.
- Divert voice calls to your colleague if you are already using the phone.

To set your call diverting options:

1. Select the required type of call diverting by pressing the **⏏** or **⏏** key and then press the **Select** soft key.
2. Select the type of calls to be diverted by pressing the **⏏** or **⏏** key and then press the **Select** soft key.

The current status is displayed. If the option has already been set, the number to which the calls are diverted is displayed.

3. To...	Press the...
activate call diverting	Activate soft key and go to Step 4.
change the call number	Change soft key and go to Step 4.
deactivate call diverting	Remove soft key.

4. Enter the number to which the calls are to be diverted and press the **OK** soft key.
To enter an international code, press the **0** key until the **+** sign is displayed.

The phone sends your settings to the network and the network's acknowledgment is displayed.

You can deactivate all of the call diverting settings by selecting the **Cancel All** option.

Call Barring *(Menu 6.2)*

The call barring network service allows you to restrict your calls.

Call barring can be set up in the following ways:

All Outgoing: calls cannot be made.

International: international calls cannot be made.

International Except to Home: when abroad, calls can be made only to numbers within the current country and to your home country, that is the country where your home network provider is located.

All Incoming: calls cannot be received.

Incoming While Abroad: calls cannot be received when you are using your phone outside your home service area.

Cancel All: all call barring settings are deactivated; calls can be made and received normally.

You can specify individual barring options for each of the following call types:

- Voice calls only
- Fax calls only
- Data calls only

To set your call barring options:

1. Select the required type of call barring by pressing the **⏏** or **⏏** key and then press the **Select** soft key.
2. Select the type of calls to be barred by pressing the **⏏** or **⏏** key and then press the **Select** soft key.

3. Press the **Activate** soft key to confirm your settings.
4. Enter your call barring password supplied by your service provider.

The phone sends your settings to the network and the network's acknowledgment is displayed.

To deactivate specific call barring settings:

1. Select the call barring option to be deactivated.
2. Select the type of call to which this option applies.
3. Press the **Deactivate** soft key.
4. Enter your call barring password supplied by your service provider.

The phone sends your settings to the network and the network's acknowledgment is displayed.

You can also deactivate all call barring settings by selecting the **Cancel All** option.

Change Barring Password: you can set and change the call barring password obtained from your service provider using this option. You must enter the current password before you can specify a new one.

Once you have entered a new password, you are asked to confirm it by entering it again.

Call Waiting *(Menu 6.3)*

This network service enables you to be informed when someone is trying to reach you during another call.

To set the call waiting option:

1. Select the **Voice Calls** option and press the **Select** soft key.

The screen informs you whether call waiting is activated or deactivated.

Note: Additional call types may be available depending on your SIM card.

2. You can activate or deactivate the call waiting feature as necessary, by using the **Activate** or **Deactivate** soft key respectively.

To return to the previous screen, press the **Exit** soft key.

You can also deactivate the call waiting setting by selecting the **Cancel All** option.

Network Selection *(Menu 6.4)*

The Network Selection feature enables you to indicate whether the network used when roaming outside your home area is selected automatically or manually.

Note: You can select a network other than your home network only if it has a valid roaming agreement with your home network.

To indicate whether the network is to be selected automatically or manually when roaming:

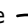
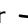
1. When **Network Selection** is displayed, press the **Select** soft key.
2. Press the  or  key until the appropriate option is highlighted and then press the **OK** soft key.

If you select **Automatic**, you are connected to the first available network when roaming.

If you select **Manual**, the phone scans for the available networks. Go to Step 3.

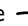
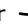
3. Press the  or  key until the preferred network is highlighted and then press the **OK** soft key.

You are connected to that network.

Caller ID *(Menu 6.5)*

You can prevent your phone number from being displayed on the phone of the person being called.

Note: Some networks do not allow the user to change this setting.

The following options are available:

Default: the default setting provided by the network is used.

Hide Number: your number is not displayed on the other person's phone.

Send Number: your number is sent each time you make a call.

Closed User Group (CUG) *(Menu 6.6)*

This network service allows incoming and outgoing calls to be restricted to a selected user group. You may be a member of up to ten user groups.

For details about how to create, activate and use a closed user group, contact your service provider.

Example: A company lends SIM cards to its employees and wants to restrict outgoing calls to members of the same team.

The following options are available:

Index List: lets you list, add or delete CUG index numbers. The list of current CUG indexes appears.

Add a new CUG index as advised by your service provider or delete a selected group.

To...	Press the...
scroll through the existing CUG indexes	← or → key.
add a new CUG index	Options soft key, select the Add option and enter the index.
delete a CUG index	Options soft key and select the Delete option.
activate a CUG index	Options soft key and select the Activate option.

Outside Access: lets you enable or disable calls to numbers other than those nominated for the Closed User Group. This feature depends on the nature of your CUG subscription. Please check with your service provider.

Default Group: you may set a default CUG with your service provider. If you have done so, you can enable the **Default Group** option on your phone. When making a call, you will be given the option of using your default CUG, instead of selecting one from the list.

Deactivate: deactivates the CUG function. This menu appears only when the default group is enabled or a CUG index is selected.

Fun Box

The **Fun Box** menu contains several fun options.

Games *(Menu 7.1)*

You can enjoy three games with your phone.

Scroll to the desired game using the ← and → keys and press the **Select** soft key.

The options for the game is displayed. To select an option, press the corresponding number key. The following options are available:

Newgame: starts a new game.

HighScore: shows the highest scores list. Up to 5 gamers can be ranked. Not all games have this option.

Key Info.: provides you the help screen, illustrating the key operation in the game.



Continue: allows you to continue the game you previously saved. This option is available only when you saved a game.

WAP Browser *(Menu 7.2)*

Your phone is equipped with a WAP (Wireless Application Protocol) browser to allow you to access and navigate the Wireless Web via your phone.

Home

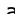
Selecting this option connects the phone to the network and loads the homepage of the Wireless Web service provider.

The content of the WAP Browser startup homepage depends on your Wireless Web service provider. To scroll through the screen, use the  and  keys.

Note: To access the startup homepage from any other screen in the WAP browser, use the Home option. For more information on the WAP Browser menus, refer to page 108.

Using the Soft Keys



A bar containing browser commands is located at the bottom of the WAP browser display. The soft keys () below the bar are used to execute these commands. The two keys are called soft keys because their function changes depending on the WAP browser application in use.

Navigating the WAP Browser

To...

scroll through and select browser items

Then...

press the  or  keys until the symbol  points to the required item, and then press the **OK** soft key to confirm the selection.

To...

select a numbered item

return to the previous page

return to the startup homepage

Then...

press the corresponding numeric key.

press the **Back** soft key or the **C** key.

select the **Home** menu option; for more information about this option, refer to page 108.

Entering Text, Numbers or Symbols

When you are prompted to enter text, the current text entry mode is indicated on the screen. The following modes are available:

SYM: allows you to enter various symbols and punctuation marks. To scan through the symbol list, use the navigation keys. When the desired symbol is selected, press the left soft key

123: allows you to enter numbers.

ABC: allows you to enter letters in the alphabet. Press the corresponding key until the required letter is displayed. You can change the case by pressing the # key.

- ABC: Initial capitalize. After entering a word, the case automatically changes to abc mode.
- abc: Lower case.
- +ALPH: Upper case.

To...	Then...
Change modes	Press the right soft key.
Enter a space	Press the] key.
Switch between upper and lower-case	Press the # key.
Edit text	Set the cursor to the right of the character to be corrected. Press the C key as required and enter the correct character(s).



Exiting the WAP Browser

To exit the browser at any time, simply press the  key.

Selecting and Using Browser Menu Options

Various menu options are available when you are using the WAP Browser to navigate the Wireless Web.

To access a menu option:

1. Press and hold down the  key. A menu displays.
2. Highlight the required menu option by pressing the **←** or **→** key.
3. Select the option by pressing the  soft key.
4. If necessary, select the secondary option using the **←** and **→** keys, and press the  soft key.

Note: The menus may vary, depending on your version of the WAP browser.

The following menu options are available:

Back: reloads the previous page in the history.

Home: takes you back at any time to the homepage of the Wireless Web service provider.

Exit: lets you exit the current browser.

Mark Site: allows you to set a bookmark for most pages so that you can access them directly from any web page.

Bookmarks: allows you to load a bookmarked Web page directly.

Inbox: displays all of the web alerts.

Save Image: allows you to save the displayed image on the current page. you can see the saved image in **Pictures** of the **Downloads** menu option (**Menu 7.3**).

Reload: reloads the current page.

Settings: gives you access to the following setting features.

Homepage: you can change the startup homepage manually.

Proxy: allows you to change the proxy server to the desired one without ending the current wap session establishment.

Circuit Prompt: allows you to set the prompt confirming your selection to display each time you access a site without wap session establishment. Select **ON** to display the confirming window, or **OFF** not to display.

Circuit Linger: allows you to set how long the phone waits for before ending the attempt for connection when there is no answer from the network. It is preset to **60 sec**.

Scroll Mode: lets you select the scroll mode between **Block** and **Smooth**.

Scroll Speed: allows you to set the speed for scrolling to the next screen. You can select **Fast**, **Medium**, and **Slow**.

Key Press Timeout: allows you to set how fast the phone recognises your selection with one keypress. You can select **Fast**, **Medium**, and **Slow**.

Security: displays all information about security, such as Connection Prompt, Secure Prompt, Current Certificate, CA Certificates, and Encryption.

Advanced: displays the current URL address, restarts the browser without exiting it, and allows you to delete a site from the offline services list.

About: provides you with information about the version of the Mobile Browser software and the WIM (WAP Identity Module).

Favorite

This option allows you to store the URL addresses of your favourite Web sites. You can access this menu directly by pressing and holding down the  key while using the WAP Browser.

To store a URL address:

1. Select an empty location and press the **Options** soft key.
2. Enter the address and press the **Enter** soft key.
3. Enter a name for the favourite item and press the **Enter** soft key.

After saving favourite items, you can use the following options by pressing the **Options** soft key:

Goto URL: quickly accesses you to the site.

Edit: allows you to edit the selected address.

Erase: deletes the selected address.

http://

This options allows you to manually enter the URL address of the Web site that you wish to access. You can access this menu directly by pressing and holding the  key down in the WAP browser.

Setting

This option allows you to set up five proxy servers for the WAP browser. Contact your service provider for details about setting options.

For each server, the following options are available:

Profile Name: Enter a name that you wish to assign to the HTTP proxy server.

Homepage URL: Set the address of your startup homepage. When the default homepage is displayed, you can delete it using the **C** key and enter your own choice.

Security: Set to desired data transmission mode. Choose **Secure** to protect your data against unauthorised access; otherwise, choose **Non-secure**.

IP Address: WAP gateway address required to connect to the Internet.

Login Name: Set the PPP server login ID.

Password: Set the PPP server password.

Dial-up Number: PPP server phone number.

Data Call Type: Data call type: **Analogue** or **ISDN**.

Note: The WAP browser settings may vary, depending on the service provider. Contact your service provider for further information.

Clear Cache

You can clear the information stored in the cache, the phone's temporary memory which stores the most recently accessed Web pages.

Press the **Yes** soft key to confirm the deletion. Otherwise, press the **No** soft key.

Downloads *(Menu 7.3)*

You can view the items you downloaded from the wireless web.

Sounds

In this menu, you can view the list of sounds downloaded from the server. You can set the downloaded sounds as the current ring tone, but cannot send the sounds to other phones.

When the memory is full, a warning message is displayed and the phone rejects additional sounds until you erase obsolete ones.

Pictures

In this menu, you can view the list of pictures downloaded from the server. You can set the downloaded pictures as the current background image, but cannot send them to other phones.

When the memory is full, a warning message is displayed and the phone rejects additional pictures until you erase obsolete ones.

Solving Problems

Before contacting the after-sales service, perform the following simple checks. They may save you the time and expense of an unnecessary service call.

When you switch your phone on, the following messages may appear

Insert SIM Card

- Check that the SIM card is correctly installed.

Phone Locked Enter Password

- The automatic locking function has been enabled. You must enter the phone's password before you can use the phone.

Enter PIN

- You are using your phone for the first time. You must enter the Personal Identification Number supplied with the SIM card.
- The PIN Check feature is enabled. Every time the phone is switched on, the PIN have to be entered. To disable the feature, use the **PIN Check** menu option (**Menu 4.6.1**).

Enter PUK

- The PIN code was entered incorrectly three times in succession and the phone is now blocked. Enter the PUK supplied by your network operator.

“No service,” “Network failure” or “Not done” is displayed

- The network connection was lost. You may be in a weak signal area (in a tunnel or surrounded by buildings). Move and try again.
- You are trying to access an option for which you have not taken out a subscription with your service provider. Contact the service provider for further details.

You have entered a number but it was not dialled

- Have you pressed the  key?
- Are you accessing the right cellular network?
- You may have set an outgoing call barring option.

Your correspondent cannot reach you

- Is your phone switched on (the  key pressed for more than one second)?
- Are you accessing the right cellular network?
- You may have set an incoming call barring option.



Your correspondent cannot hear you speaking

- Have you switched off the microphone?
- Are you holding the phone close enough to your mouth? The microphone is located at the bottom of the phone.

The phone starts beeping and “Warning** Low Battery” flashes on the display**

- The battery is insufficiently charged. Replace the battery and recharge it.

The audio quality of the call is poor

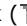
- Check the signal strength indicator on the display (); the number of bars indicates the signal strength from strong () to weak ().
- Try moving the phone slightly or moving closer to a window if you are in a building.

No number is dialled when you recall a phonebook entry

- Check that the number has been stored correctly, by using the Phonebook Search feature.
- Re-store the number, if necessary.

If the above guidelines do not help you to solve the problem, take a note of:

- The model and serial numbers of your phone
- Your warranty details
- A clear description of the problem

Then contact your local dealer or Samsung after-sales service.

Access Codes

There are several access codes that are used by your phone and its SIM card. These codes help you protect the phone against unauthorised use.

When requested for any of the codes explained below, key in the appropriate code (displayed as asterisks) and press the **OK** soft key. If you make a mistake, press the **C** key one or more times until the incorrect digit is cleared and then continue entering the correct code.

The access codes, except for the PUK (PIN Unblocking Key) and PUK2 codes can be changed using **Security** menu options (**Menu 4.6**). See page 79 for further details.

Important! Avoid using access codes resembling emergency numbers, such as 112, so that you do not dial an emergency number accidentally.

Phone Password

The Phone Lock feature uses the phone password to protect your phone against unauthorised use. The phone password is supplied with the phone and is factory set to "00000000."

To...	Refer to...
activate/deactivate the Phone Lock feature	page 80 (menu option 4.6.3).
change the phone password	page 81 (menu option 4.6.4).

PIN

The **Personal Identification Number** or PIN (4 to 8 digits) protects your SIM card against unauthorised use. It is usually supplied with the SIM card.

If you enter an incorrect PIN three times in succession, the code is disabled and cannot be used until you re-enable it by entering the PUK (see below).

To...	Refer to...
activate/deactivate the PIN Check feature	page 80 (menu option 4.6.1).
change the PIN	page 80 (menu option 4.6.2).

PUK

The 8-digit PUK (**Pin Unblocking Key**) is required to change a disabled PIN. The PUK may be supplied with the SIM card. If not, or you have lost it, contact your service provider.

To re-enable your PIN:

1. Key in the PUK and press the **OK** soft key.
2. Enter a new PIN of your choice and press the **OK** soft key.
3. When the **Confirm New PIN** message is displayed, key in the same code again and press the **OK** soft key.

If you enter an incorrect PUK ten times in succession, the SIM card becomes invalid. Contact your service provider for a new card.

PIN2

The PIN2 (4 to 8 digits), supplied with some SIM cards, is required to access specific functions, such as setting the maximum cost of a call. These functions are available if supported by your SIM card.

If you enter an incorrect PIN2 three times in succession, the code is disabled and you cannot access the functions until you re-enable it by entering the PUK2.

To change the PIN2, refer to page 82 (menu option **4.6.7**).

PUK2

The 8-digit PUK2 (**P**in **U**nblocking **K**ey **2**), supplied with some SIM cards, is required to change a disabled PIN2. If you lose the code, contact your service provider.

To re-enable your PIN2:

1. Key in the PUK2 and press the **OK** soft key.
2. Enter a new PIN2 of your choice and press the **OK** soft key.
3. When the **Confirm PIN2** message is displayed, key in the same code again and press the **OK** soft key.

If you enter an incorrect PUK2 ten times in succession, you will not be able to access the functions requiring the PIN2. Contact your service provider for a new card.

Barring Password

The 4-digit barring password is required when you use the Call Barring function. You obtain the password from your service provider when you subscribe to this function. See page 100 for further details.

Health and Safety Information

Exposure to Radio-Frequency Energy (SAR Information)

This phone meets European Union (EU) requirements concerning exposure to radio waves.

Your mobile phone is a radio transmitter and receiver. It is designed and manufactured, so as not to exceed the limits for exposure to radio-frequency (RF) energy, as recommended by the EU Council. These limits are part of comprehensive guidelines and establish permitted levels of RF energy for the general population. The guidelines were developed by independent scientific organisations through periodic and thorough evaluation of scientific studies. The limits include a substantial safety margin designed to ensure the safety of all persons, regardless of age and health.

The exposure standard for mobile phones employs a unit of measurement known as SAR (Specific Absorption Rate). The SAR limit recommended by the EU Council is 2.0W/kg.*

*: The SAR limit for mobile phones used by the public is 2.0 watts/kilogram (W/kg) averaged over ten gram of body tissue. The limit incorporates a substantial margin of safety to give additional protection for the public and to account for any variations in measurements. The SAR values may vary depending on national reporting requirements and the network band.

SAR tests are conducted using standard operating positions with the phone transmitting at its highest certified power level in all tested frequency bands. Although the SAR is determined at the highest certified power level, the actual SAR level of the phone while operating can be well below the maximum value. This is because the phone is designed to operate at multiple power levels so as to use only the power required to reach the network. In general, the closer you are to a base station, the lower the power output of the phone.

The highest SAR value for this model phone when tested for compliance against the standard was 0.434W/kg. While there may be differences between the SAR levels of various phones and various positions, they all meet the EU requirements for RF exposure.

Precautions When Using Batteries

Your phone is powered by a rechargeable Li-ion standard battery.

- Never use any charger or battery that is damaged in any way.
 - Use the battery only for its intended purpose.
 - If you use the phone near the network's base station, it uses less power; talk and standby time are greatly affected by the signal strength on the cellular network and the parameters set by the network operator.
 - Battery charging time depends on the remaining battery charge and the type of battery and charger used. The battery can be charged and discharged hundreds of times, but it will gradually wear out. When the operation time (talk time and standby time) is noticeably shorter than normal, it is time to buy a new battery.
 - If left unused, a fully charged battery will discharge itself over time.
 - Use only Samsung-approved batteries and recharge your battery only with Samsung-approved chargers. When a charger is not in use, disconnect it from the power source. Do not leave the battery connected to a charger for more than a week, since overcharging may shorten its life.
 - Extreme temperatures will affect the charging capacity of your battery: it may require cooling or warming first.
- Do not leave the battery in hot or cold places, such as in a car in summer or winter conditions, as you will reduce the capacity and life-time of the battery. Always try to keep the battery at room temperature. A phone with a hot or cold battery may temporarily not work, even when the battery is fully charged. Li-ion batteries are particularly affected by temperatures below 0 °C (32 °F).
 - Do not short-circuit the battery. Accidental short circuiting can occur when a metallic object (coin, clip or pen) causes a direct connection between the + and - terminals of the battery (metal strips on the back of the battery), for example when you carry a spare battery in a pocket or bag. Short-circuiting the terminals may damage the battery or the object causing the short-circuit.
 - Dispose of used batteries in accordance with local regulations. Always recycle. Do not dispose of batteries in a fire.

Road Safety

Your wireless phone gives you the powerful ability to communicate by voice, almost anywhere, anytime. But an important responsibility accompanies the benefits of wireless phones, one that every user must uphold.

When driving a car, driving is your first responsibility. When using your wireless phone behind the wheel of a car, practice good common sense and remember the following tips:

1. Get to know your wireless phone and its features, such as speed dial and redial. If available, these features help you to place your call without taking your attention off the road.
2. When available, use a hands-free device. If possible, add an extra layer of convenience and safety to your wireless phone with one of the many hands-free accessories available today.
3. Position your wireless phone within easy reach. Be able to access your wireless phone without removing your eyes from the road. If you get an incoming call at an inconvenient time, let your voice mail answer it for you.
4. Let the person you are speaking with know you are driving; if necessary, suspend the call in heavy traffic or hazardous weather conditions. Rain, sleet, snow, ice and even heavy traffic can be hazardous.
5. Do not take notes or look up phone numbers while driving. Jotting down a To Do list or flipping through your phonebook takes your attention away from your primary responsibility, driving safely.
6. Dial sensibly and assess the traffic; if possible, place calls when you are not moving or before pulling into traffic. Try to plan calls when your car will be stationary. If you need to make a call while moving, dial only a few numbers, check the road and your mirrors, then continue.
7. Do not engage in stressful or emotional conversations that may be distracting. Make the people with whom you are talking aware that you are driving and suspend conversations that have the potential to divert your attention from the road.
8. Use your wireless phone to call for help. Dial the emergency number in the case of fire, traffic accident or medical emergencies. Remember, it is a free call on your wireless phone!
9. Use your wireless phone to help others in emergencies. If you see a car accident, crime in progress or other serious emergency where lives are in danger, call the emergency number, as you would want others to do for you.
10. Call roadside assistance or a special non-emergency wireless assistance number when necessary. If you see a broken-down vehicle posing no serious hazard, a broken traffic signal, a minor traffic accident where no one appears injured, or a vehicle you know to be stolen, call roadside assistance or any other special non-emergency wireless number.

Operating Environment

Remember to follow any special regulations in force in any area and always switch off your phone whenever it is forbidden to use it, or when it may cause interference or danger.

When connecting the phone or any accessory to another device, read its user's guide for detailed safety instructions. Do not connect incompatible products.

As with other mobile radio transmitting equipment, users are advised that for the satisfactory operation of the equipment and for the safety of personnel, it is recommended that the equipment should only be used in the normal operating position (held to your ear with the antenna pointing over your shoulder).

Electronic Devices

Most modern electronic equipment is shielded from radio frequency (RF) signals. However, certain electronic equipment may not be shielded against the RF signals from your wireless phone. Consult the manufacturer to discuss alternatives.

Pacemakers

Pacemaker manufacturers recommend that a minimum distance of 15 cm (6 inches) be maintained between a wireless phone and a pacemaker to avoid potential interference with the pacemaker. These recommendations are consistent with the independent research and recommendations of Wireless Technology Research.

Persons with pacemakers:

- Should always keep the phone more than 15 cm (6 inches) from their pacemaker when the phone is switched on
- Should not carry the phone in a breast pocket
- Should use the ear opposite the pacemaker to minimise potential interference

If you have any reason to suspect that interference is taking place, switch off your phone immediately.

Hearing Aids

Some digital wireless phones may interfere with some hearing aids. In the event of such interference, you may wish to consult your hearing aid manufacturer to discuss alternatives.

Other Medical Devices

If you use any other personal medical devices, consult the manufacturer of your device to determine if it is adequately shielded from external RF energy. Your physician may be able to assist you in obtaining this information. Switch off your phone in health care facilities when any regulations posted in these areas instruct you to do so. Hospitals or health care facilities may be using equipment that could be sensitive to external RF energy.

Vehicles

RF signals may affect improperly installed or inadequately shielded electronic systems in motor vehicles. Check with the manufacturer or its representative regarding your vehicle.

You should also consult the manufacturer of any equipment that has been added to your vehicle.

Posted Facilities

Switch off your phone in any facility where posted notices require you to do so.

Potentially Explosive Atmospheres

Switch off your phone when in any area with a potentially explosive atmosphere and obey all signs and instructions. Sparks in such areas could cause an explosion or fire resulting in bodily injury or even death.

Users are advised to switch off the phone while at a refuelling point (service station). Users are reminded of the need to observe restrictions on the use of radio equipment in fuel depots (fuel storage and distribution areas), chemical plants or where blasting operations are in progress.

Areas with a potentially explosive atmosphere are often but not always clearly marked. They include below deck on boats, chemical transfer or storage facilities, vehicles using liquefied petroleum gas (such as propane or butane), areas where the air contains chemicals or particles, such as grain, dust or metal powders, and any other area where you would normally be advised to turn off your vehicle engine.

Emergency Calls

This phone, like any wireless phone, operates using radio signals, wireless and landline networks as well as user-programmed functions, which cannot guarantee connection in all conditions. Therefore, you should never rely solely on any wireless phone for essential communications (medical emergencies, for example).

Remember, to make or receive any calls the phone must be switched on and in a service area with adequate signal strength. Emergency calls may not be possible on all wireless phone networks or when certain network services and/or phone features are in use. Check with local service providers.

To make an emergency call:

1. If the phone is not on, switch it on.
2. Key in the emergency number for your present location (for example, 999 or other official emergency number). Emergency numbers vary by location.
3. Press the  key.

If certain features are in use (call barring, for example), you may first need to deactivate those features before you can make an emergency call. Consult this document and your local cellular service provider.

When making an emergency call, remember to give all the necessary information as accurately as possible. Remember that your phone may be the only means of communication at the scene of an accident; do not cut off the call until given permission to do so.

Other Important Safety Information

- Only qualified personnel should service the phone or install the phone in a vehicle. Faulty installation or service may be dangerous and may invalidate any warranty applicable to the device.
- Check regularly that all wireless phone equipment in your vehicle is mounted and operating properly.
- Do not store or carry flammable liquids, gases or explosive materials in the same compartment as the phone, its parts or accessories.
- For vehicles equipped with an air bag, remember that an air bag inflates with great force. Do not place objects, including both installed or portable wireless equipment in the area over the air bag or in the air bag deployment area. If wireless equipment is improperly installed and the air bag inflates, serious injury could result.
- Switch off your phone before boarding an aircraft. The use of wireless phones in aircraft may be dangerous to the operation of the aircraft, and is illegal.
- Failure to observe these instructions may lead to the suspension or denial of telephone services to the offender, or legal action, or both.

Care and Maintenance

Your phone is a product of superior design and craftsmanship and should be treated with care. The suggestions below will help you fulfill any warranty obligations and allow you to enjoy this product for many years.

- Keep the phone and all its parts and accessories out of the reach of small children's.
- Keep the phone dry. Precipitation, humidity and liquids contain minerals that will corrode electronic circuits.
- Do not touch the phone with wet hands while it is charging. Doing so may give you an electric shock or damage the phone.
- Do not use or store the phone in dusty, dirty areas, as its moving parts may be damaged.
- Do not store the phone in hot areas. High temperatures can shorten the life of electronic devices, damage batteries, and warp or melt certain plastics.
- Do not store the phone in cold areas. When the phone warms up to its normal operating temperature, moisture can form inside the phone, which may damage the phone's electronic circuit boards.
- Do not drop, knock or shake the phone. Rough handling can break internal circuit boards.
- Do not use harsh chemicals, cleaning solvents or strong detergents to clean the phone. Wipe it with a soft cloth slightly dampened in a mild soap-and-water solution.

- Do not paint the phone. Paint can clog the device's moving parts and prevent proper operation.
- Do not put the phone in or on heating devices, such as a microwave oven, a stove or a radiator. The phone may explode when overheated.
- Use only the supplied or an approved replacement antenna. Unauthorised antennas or modified accessories may damage the phone and violate regulations governing radio devices.
- If the phone, battery, charger or any accessory is not working properly, take it to your nearest qualified service facility. The personnel there will assist you, and if necessary, arrange for service.

Glossary

To help you understand the main technical terms and abbreviations used in this booklet and take full advantage of the features on your mobile phone, here are a few definitions.

Active Folder

Ability to answer a call simply by opening the folder cover.

Call Barring

Ability to restrict outgoing and incoming calls.

Call Diverting

Ability to reroute calls to another number.

Call Holding

Ability to put one call on standby while answering or making another call; you can then switch between the two calls, as required.

Call Waiting

Ability to inform users that they have an incoming call when engaged on another call.

Caller Line Identification Services (Caller ID)

Services allowing subscribers to view or block the telephone numbers of callers.

DCS

Digital cellular network standard based on the GSM network architecture. With the higher frequency range (1800 MHz for DCS instead of 900 MHz for GSM), more radio channels can be made available, thus allowing the network to support more subscribers and traffic.

Dual Band

Ability to operate with both DCS (1800 MHz) and GSM (900 MHz) networks. The phone automatically uses the network with the strongest signal and even switches networks during a call within the same operator's network.

GSM (Global System for Mobile Communication)

International standard for cellular communication, guaranteeing compatibility between the various network operators. GSM covers most European countries and many other parts of the world.

Multiparty Calling

Ability to establish a conference call involving up to five additional parties.

Phone Password

Security code used to unlock the phone when you have selected the option to lock it automatically each time it switches on.

PIN (Personal Identification Number)

Security code that protects the phone against unauthorised use. The PIN is supplied by the service provider with the SIM card. It may be a four to eight-digit number and can be changed, as required.

PUK (PIN Unblocking Key)

Security code used to unlock the phone when an incorrect PIN has been entered three times in succession. The eight-digit number is supplied by the service provider with the SIM card.

Roaming

Use of your phone when you are outside your home area, when travelling for example.

SDN (Service Dialling Numbers)

Telephone numbers supplied by your network provider and giving access to special services, such as voice mail, directory inquiries, customer support and emergency services.



SIM (Subscriber Identification Module)

Card containing a chip with all the information required to operate the phone (network and memory information, as well as the subscriber's personal data). The SIM card fits into a small slot on the back of the phone and is protected by the battery.

SMS (Short Message Service)

Network service sending and receiving messages to and from another subscriber without having to speak to the correspondent. The message created or received can be displayed, received, edited or sent.

Soft Keys

Two keys marked  and  on the phone, the purpose of which:

- Varies according to the function that you are currently using.
- Is indicated on the bottom line of the display just above the corresponding key.



Voice Mail

Computerised answering service that automatically answers your calls when you are not available, plays a greeting (optionally in your own voice) and records a message.

Dual Band SGH-T200 GSM Telephone Quick Reference Card

Access the Menu Function

- 1 Press the **Menu** soft key, in idle mode
- 2 Scroll with the **←** and **→** keys through the list of the menus until you reach the required menu.
- 3 Press the **Select** soft key.
- 4 Scroll with the **←** and **→** keys through the list of the options until the required one is selected.
- 5 Press the **Select** soft key.

- Each of the two soft keys ( and ) perform the function indicated by the text above it (on the bottom line of the display.)

Switch On/Off

Press and hold the  key.

Makes a Call

- 1 Enter the number.
- 2 Press the  key.

End a Call

Briefly press the  key.

View Missed Calls Immediately After Missing Them

- 1 Open the folder and press the **View** soft key.
- 2 Scroll with the **←** and **→** keys through the missed calls.
- 3 To return the call, press the  key.



Answer a Call	Open the phone or press the ☎ key.	Store Numbers in the Phonebook <i>(continued...)</i>	<ol style="list-style-type: none"> Press the OK soft key. If necessary, change the location. Press the OK soft key. Press the ☎ key to return to idle mode.
Adjust the Volume	Press the ▲ or ▼ key on the left side of the phone.	Search for a Number in the Phonebook	<ol style="list-style-type: none"> Press the Name soft key. Select the Search option. Enter the name. To scroll through the names, press the ← or → key. Press the View soft key. To scroll through the numbers, press the ← or → key. Press the key ☎ to dial.
Choose the Alert Type	<ol style="list-style-type: none"> Select the Alert Type menu option (3.3) Select an option: Melody, Vibration or Vibrate+Melody. Press the OK soft key. 		
Store a Number in the Phonebook	<ol style="list-style-type: none"> Enter the number. Press the Save soft key. Select an icon for a category. Press the Select soft key. Enter a name. 		